

# X7

 Quattro™



Owner's Manual

**BARACUDA®**  
*The World's Simplest Automatic Pool Cleaners*

# Important Information

**Notice for Vinyl Liner Pools:** Before installing your new automatic pool cleaner, examine the interior of your pool carefully. If the vinyl liner is brittle or has stones, wrinkles, roots or metal corrosion in contact with the underside of the liner, or has damage to the base material or supporting walls, do not install the cleaner before having a qualified professional perform the necessary repairs or liner replacement. **Zodiac Pool Systems, Inc. will not be responsible for liner damage.** Please see the Limited Warranty.

- To help prevent suction entrapment accidents, wall vacuum fittings should have a safety vacuum lock installed. Contact your builder or retail pool professional for details.
- Clean the skimmer basket, pump basket and pool filter before installing the cleaner and on a regular basis thereafter.
- Always disconnect the cleaner before cleaning or backwashing the pool filter. After cleaning, let the filtration system run for at least five minutes before re-connecting the cleaner.
- Remove the cleaner from the pool before chemical or shock treatments. Wait a minimum of four hours after super chlorination before re-installing the cleaner.

## For customer service or support:

**Zodiac Pool Systems, Inc.**

2620 Commerce Way

Vista, CA 92081-8438

1-800-822-7933

[www.zodiacpoolcare.com](http://www.zodiacpoolcare.com)

To ensure prompt warranty service, should it be required, please:

- Complete and return the Zodiac Warranty Card.
- Record your purchase information.
- Attach a copy of your purchase receipt to this document.

Date of Purchase: \_\_\_\_\_ Purchased From: \_\_\_\_\_

Serial Number (Located on underside of cleaner) \_\_\_\_\_

If service is required, simply present your owner's manual with the attached receipt at any Zodiac authorized warranty center nationwide.

For sale and use in the United States and Mexico only. This pool cleaner is not warranted or guaranteed outside of the United States or Mexico. This pool cleaner is covered by one or more of the following patents: US patents: 7,337,803; D575,465 and D575,466. Other patents pending.

# Introduction

Congratulations on the purchase of your new Baracuda® X7 Quattro™ automatic pool cleaner. Built with proven Baracuda® technology, the X7 Quattro™ is designed and manufactured for easy installation and years of carefree operation.

The X7 Quattro™ connects to a dedicated cleaner (suction) line or a pool skimmer. As water flows through the cleaner, dirt and debris are pulled directly into the pool filtration system.

Before installing the cleaner, please take a few moments to become familiar with its components and to review the items listed under **Important Information** on the previous page.

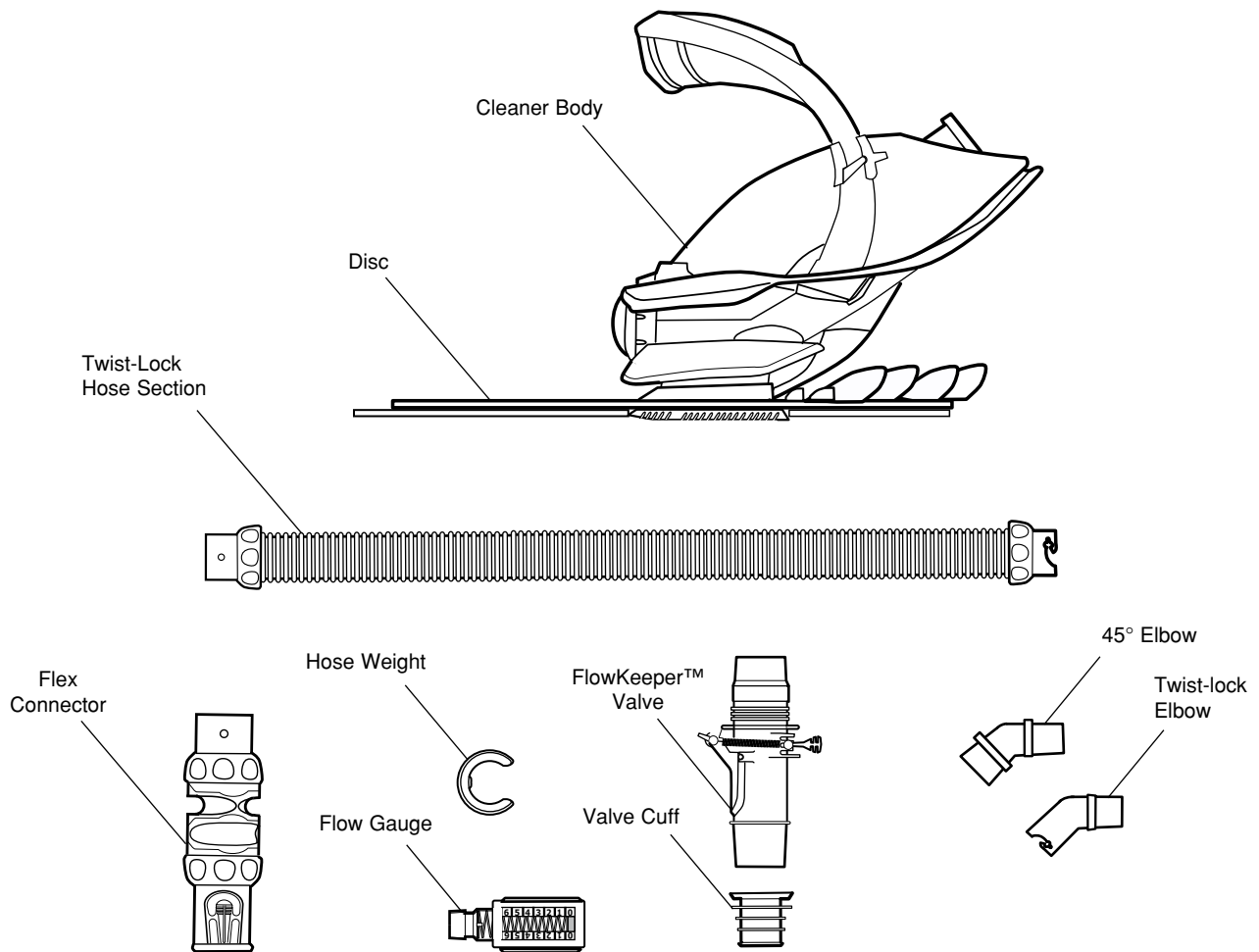

# Quick Installation

## Prepare the Pool

1. Manually vacuum the pool if excessive debris is present, and make sure the pool filter and pump basket are clean.
2. Close the pool main drain line.
3. **Adjust the return lines to blow downward to break up surface circulation and ensure complete cleaning coverage.**

- Loosen the fitting lock ring
- Redirect the eyeball downward
- Retighten the lock ring

If the return fitting cannot be adjusted, the fitting **MUST** be replaced with Zodiac return line diverter (part #W90153 for 1-1/2", #W90155 for 2" or #W24100 for pools without return fittings).

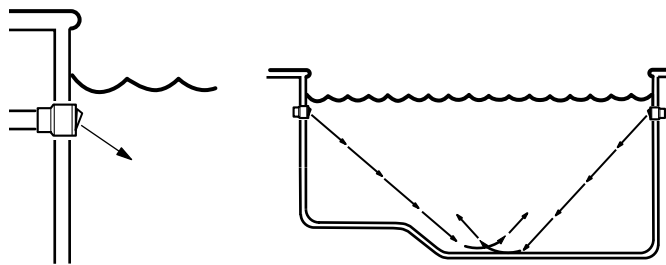

## Assemble the Hose

The hose uses easy twist-lock connectors. Push and twist the connectors on each hose section until they lock into position with a clicking sound.

1. Connect enough hose to reach the farthest point of the pool and then add one more section.
2. Position the hose weight at the end of the first hose section, about 39 inches (1m) from the cleaner.

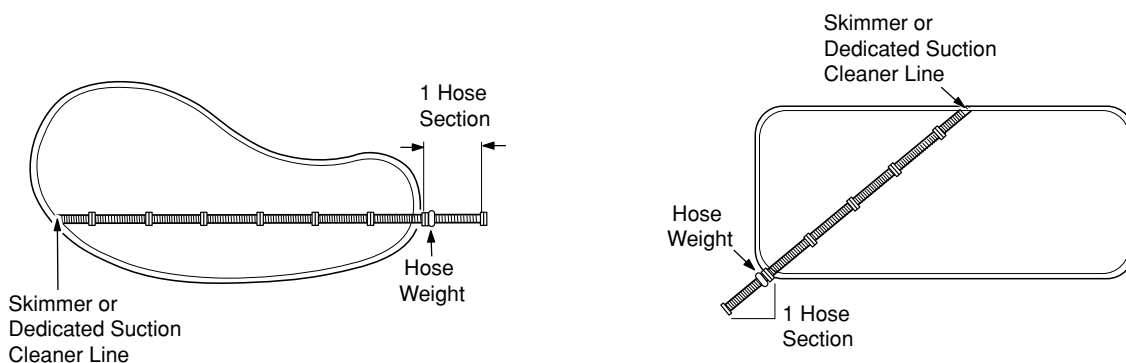

## Connect the Hose

Turn on the filtration system and fill the hose with water by placing the end in front of a return inlet until it is flooded. Turn off the pump.

### To connect to a dedicated suction line:

1. Attach the male end of the hose to the 45° twist-lock elbow.
2. Connect the elbow to the safety vac wall fitting.
3. Angle the elbow upward towards the water surface.

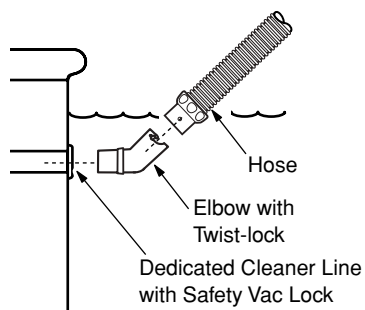

### To connect to a skimmer:

The **FlowKeeper® valve must always be used in single skimmer installations**. The valve regulates flow to ensure the pool pump and cleaner run properly. It is pre-set at the factory to optimize the performance of the cleaner, but offers three settings to adjust the flow. The lower the setting number, the lower the flow. To adjust, pull the handle and move setting up or down. The red tab can be used to open the valve and stop the cleaner.

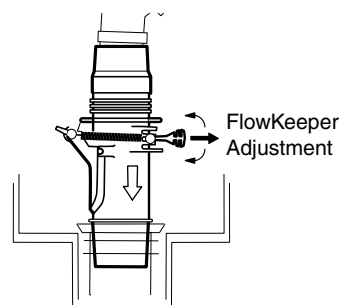

If the pool has more than one skimmer, connect the hose to the one closest to the pump.

The parts used to connect the hose and the sequence in which they are installed depend on the type of skimmer.

1. Remove the skimmer basket.
2. Insert the valve cuff and connect the FlowKeeper with the arrow pointing down towards the bottom of the skimmer.
3. Choose the fitting combination that best suits the skimmer to complete the connection. Slide the 45-degree elbow over the FlowKeeper valve and the male end of the hose over the elbow, or slide the hose directly onto the FlowKeeper valve.

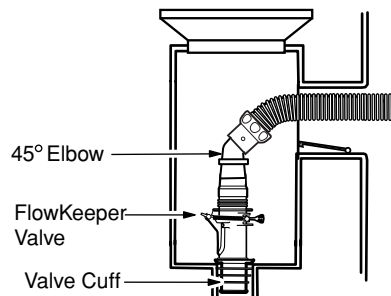

## Test and Adjust for Proper Flow

Keeping the hose submerged, attach the flex connector to the end of the hose. Click the Flow Gauge onto the connector and turn on the pump.

Verify that the red indicator in the gauge (viewed from the side) is on the Number 3 setting.

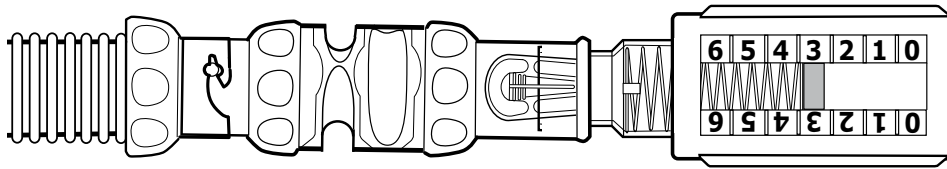

If necessary, use the valves in the pool equipment area to adjust the flow.

- **For skimmer connections on pools with one skimmer**, flow is automatically regulated by the FlowKeeper Valve. The red indicator should be at the proper setting.
- **For skimmer connections on pools with more than one skimmer**, leave the valve for the skimmer connected to the hose open, then slowly close the other skimmer until the proper setting is reached.
- **For dedicated suction line connections**, leave the vacuum line open and slowly close the skimmer line until the flow is at the proper setting.

### If flow is in the low range (0-2):

- Check and clean the pool filter and baskets if necessary.
- Verify that valves controlling the suction lines are in the correct position.

### If flow is in the high range (4-6):

- Verify that valves controlling the suction lines are in the correct position.
- Lower the flow setting on the FlowKeeper Valve.
- Open the main drain slightly to further reduce flow.

Turn off the pump. Keeping the hose underwater, remove the Flow Gauge by squeezing the pressure

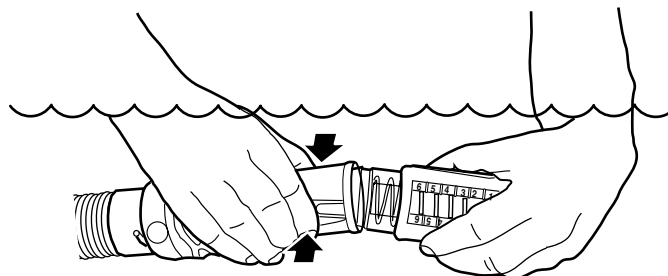

points on either side of the flex connec-

tor.

## Connect the Cleaner

1. Make sure the float/arm handle is in the full upright position and locked two handle locks.

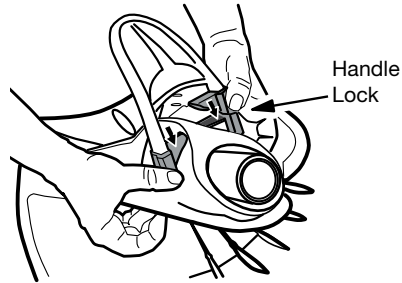

is into place with the

2. Submerge the cleaner and flood it with water.

and

3. When bubbles stop coming out of the extension pipe, connect the hose to the cleaner by pushing the flex-connector onto the outer extension pipe until it locks into position with a clicking sound.

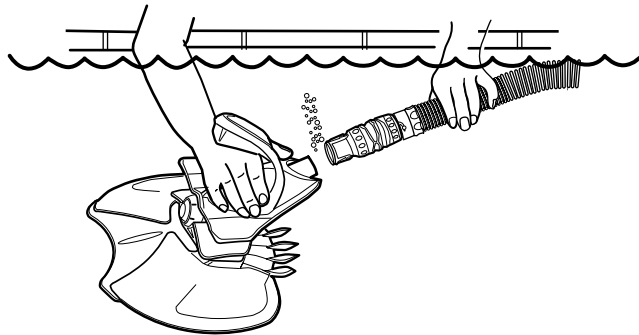

4. Allow the cleaner to drift to the bottom of the pool. Turn on the pool pump and begin cleaning. Installation is complete.

# Operation and Maintenance

## Fine Tuning Cleaner Performance

The X7 Quattro™ cycles on/off with the pool filtration pump vacuuming and cleaning all surfaces randomly throughout the pool. The coverage of the cleaner is dependent on the pool's shape and available water flow. In some applications, adjustments may be necessary to optimize cleaning coverage.

A properly balanced hose will create a 45-degree angle to the cleaner and the bottom of the pool.

In pools 8-1/2 feet or deeper, an extra hose weight (part #W83247) may be necessary. Attach the extra weight 5 to 8 feet from the cleaner.

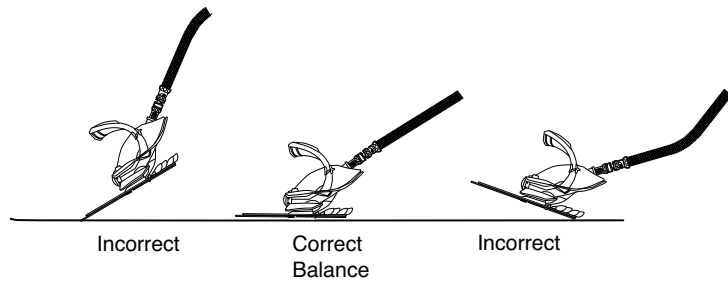

A return line can be used to guide the

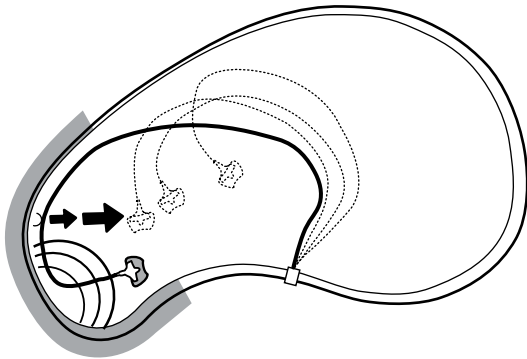

cleaner away from steps or areas with V-shaped corners, and reduce patterning.

Direct the return line to gently push the cleaner hose by positioning the return directional eyeball so it aims towards the wall on the opposite side of the pool. Adjust until surface movement is visible 8 feet out from the return.

In this example, any return within the grey area can be used.

## Routine Maintenance

To maintain performance:

- Never coil the hose. Straighten a coiled hose with warm water or by laying it in the sun for a day. **A kinked or coiled hose will adversely effect the cleaner's coverage of the pool.**
- When not in the pool, keep the disc flat to avoid warping.
- Periodically inspect cleaner parts for wear. Replace the footpad when the depths of the channels between the treads are 1/16" or less.
- Thoroughly clean the skimmer basket, pump basket and filter regularly.
- Always disconnect the cleaner from the pool wall or skimmer before cleaning or backwashing the pool filter. After cleaning or backwashing, let the filtration system run for at least five minutes before re-connecting the cleaner.



## Clearing the Diaphragm

If the cleaner stops, check the diaphragm for blockage.

1. Turn cleaner over.
2. Inspect diaphragm and push through debris or obstacles to clear.

If not blocked, check the diaphragm for wear or damage.

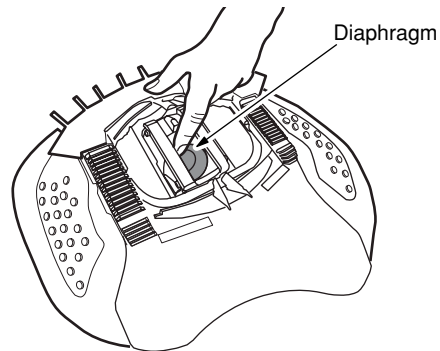

## To access or remove the diaphragm:

1. Release the handle locks and fold the handle down.

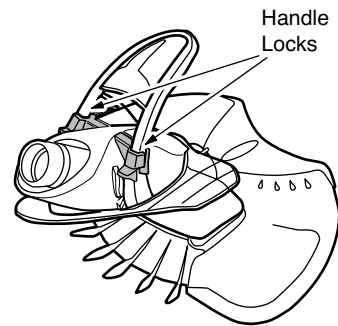

2. Remove main body cover.

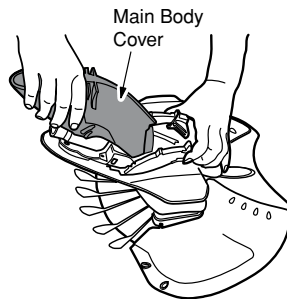

3. Lift out the cleaner engine assembly and set aside thrust washer.

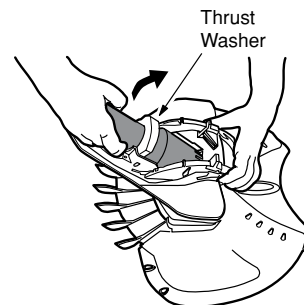

4. Unscrew the outer extension pipe from the inner extension pipe

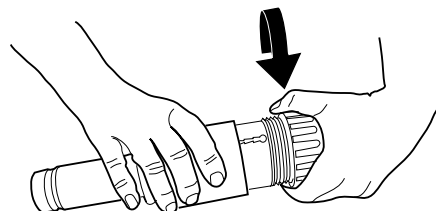

5. Separate the inner extension pipe and pull out the diaphragm.

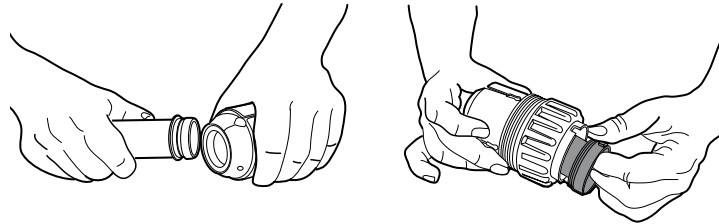

6. Inspect the diaphragm for wear and rinse it thoroughly with water. Replace it if necessary.

### To reinstall diaphragm:

1. Attach diaphragm to inner pipe.
2. Insert inner pipe and diaphragm into cup assembly. Align diaphragm tabs with notches and pull straight through (do not twist) until the edge of the diaphragm is visible.

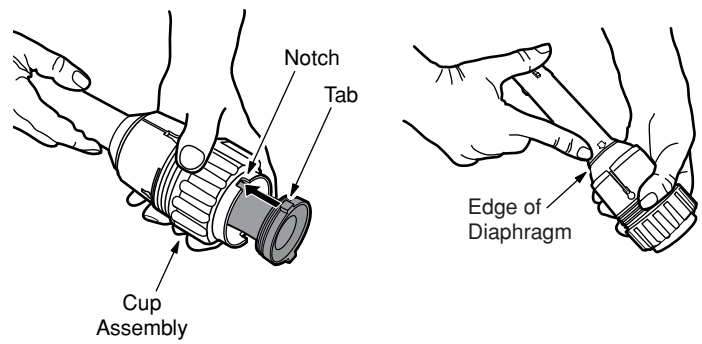

3. Thread on the outer pipe and slide the thrust washer over the ridge of the assembly.

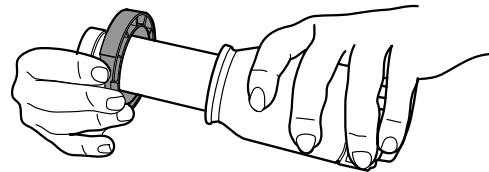

4. With the widest part of the thrust washer on top, slide the assembly between the handle and under the wing of the cleaner. Push it down until it snaps into place.

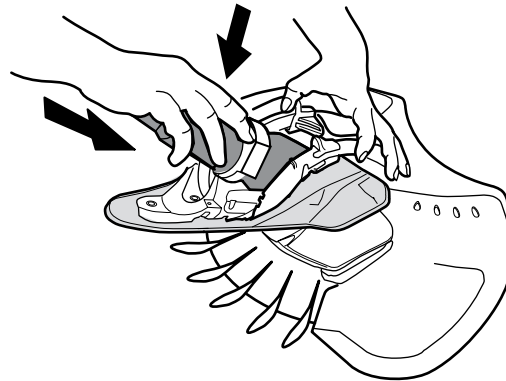

- 
5. Reinstall the main body cover

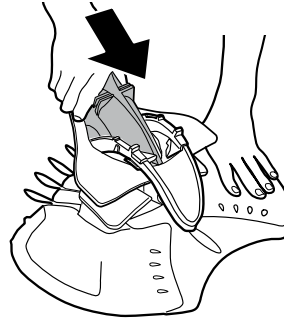

6. Rotate the handle up into position and secure the two handle locks.

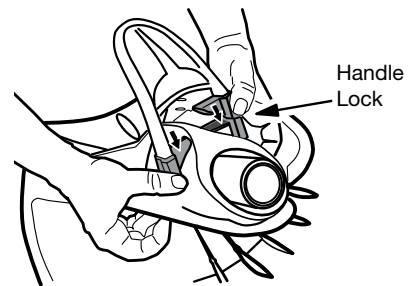
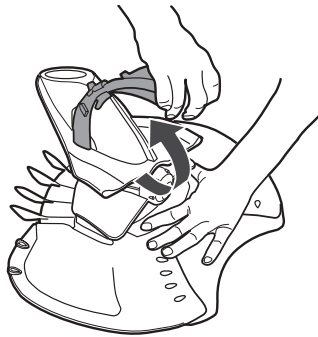

### Storage and Winterizing

Never coil the hose. Store the X7 Quattro™ out of direct sunlight. When storing for the winter, drain all water from the cleaner. Remove all connectors and adapters from the dedicated suction line or skimmer. Store the disc flat, and hose sections disconnected, drained and straight.

# Zodiac X7 Quattro™ Parts Diagram

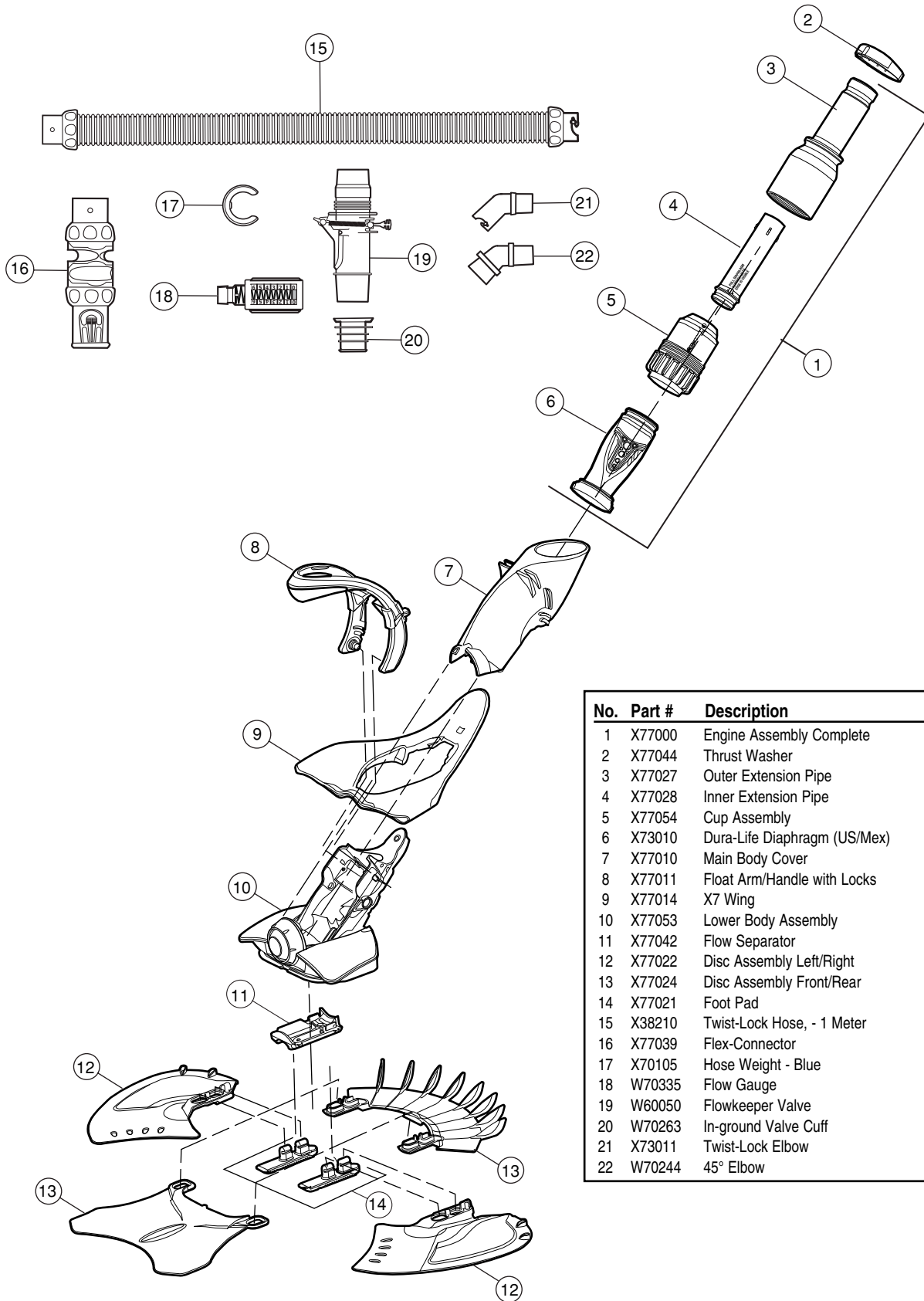

No.	Part #	Description	Qty
1	X77000	Engine Assembly Complete	1
2	X77044	Thrust Washer	1
3	X77027	Outer Extension Pipe	1
4	X77028	Inner Extension Pipe	1
5	X77054	Cup Assembly	1
6	X73010	Dura-Life Diaphragm (US/Mex)	1
7	X77010	Main Body Cover	1
8	X77011	Float Arm/Handle with Locks	1
9	X77014	X7 Wing	1
10	X77053	Lower Body Assembly	1
11	X77042	Flow Separator	1
12	X77022	Disc Assembly Left/Right	1
13	X77024	Disc Assembly Front/Rear	1
14	X77021	Foot Pad	2
15	X38210	Twist-Lock Hose, - 1 Meter	12
16	X77039	Flex-Connector	1
17	X70105	Hose Weight - Blue	1
18	W70335	Flow Gauge	1
19	W60050	Flowkeeper Valve	1
20	W70263	In-ground Valve Cuff	1
21	X73011	Twist-Lock Elbow	1
22	W70244	45° Elbow	1

# Troubleshooting

If you experience a problem with your X7 Quattro™, please follow the troubleshooting steps below to restore performance. If further assistance is required, contact Zodiac Customer Service. Please have your serial number and date of purchase available when you call.

<b>Problem</b>	<b>Solution</b>
Cleaner does not move or moves slowly.	<ul style="list-style-type: none"><li>• Use Flow Gauge to verify proper flow. Reduce flow to move cleaner off the walls.</li><li>• Confirm that the main drain is closed.</li><li>• Check diaphragm for blockage, damage or wear.</li><li>• Backwash filter and empty pump basket.</li><li>• Check for air in system. If water level in pump basket drops or you see excessive air bubbles in the pump basket or coming from the return lines, there is air in the system. Check hose connections, tighten all fittings at pump and check gasket in pump basket for wear.</li></ul>
Cleaner patterns, does not cover entire pool.	<ul style="list-style-type: none"><li>• Use Flow Gauge to verify proper flow. Reduce flow to move cleaner off the walls.</li><li>• Ensure return fittings are directed down. Add a return diverter if necessary.</li><li>• Make sure hose is not coiled or kinked. Lay in sun to straighten if necessary.</li><li>• Verify correct hose weight positioning: 29 inches (1 m) from cleaner.</li><li>• Verify that the engine assembly spins freely inside the cleaner body.</li><li>• Confirm proper hose length.</li></ul>
Cleaner gets stuck at steps.	<ul style="list-style-type: none"><li>• Use Flow Gauge to verify proper flow.</li><li>• Confirm proper hose length. Shorten if necessary.</li><li>• Use return jets to guide cleaner.</li></ul>
Cleaner stays on walls or edge of pool.	<ul style="list-style-type: none"><li>• Using Flow Gauge as guide, reduce flow to number 2 setting.</li><li>• Verify correct hose weight positioning: 29 inches (1 m) from cleaner.</li></ul>
Cleaner won't climb walls.	<ul style="list-style-type: none"><li>• Use Flow Gauge to verify proper flow, number 3 setting.</li><li>• Verify correct hose weight positioning: 29 inches (1 m) from cleaner.</li></ul>

# Baracuda® X7 Quattro™ Limited Warranty

This Baracuda® X7 Quattro™ cleaner was carefully inspected before shipment from our warehouse. Upon unpacking, if any part proves defective or missing, please notify Zodiac Pool Systems, Inc. ("Zodiac") immediately. Please refer to the information in this manual for complete instructions on the installation and operation of your X7 Quattro.

ZODIAC WARRANTS THIS X7 QUATTRO POOL CLEANER AGAINST ALL MANUFACTURING DEFECTS FOR A PERIOD OF TWO (2) YEARS. ALL WARRANTIES ARE EFFECTIVE FROM THE DATE OF PURCHASE.

Should this product prove defective in workmanship, materials or wear during the applicable warranty period, the consumer's sole and exclusive remedy shall be such repair or replacement of the product as provided below.

**THE LIMITED WARRANTY PROVIDED HEREIN IS THE SOLE AND EXCLUSIVE WRITTEN WARRANTY WITH RESPECT TO THE X7 QUATTRO POOL CLEANER. ALL IMPLIED WARRANTIES IMPOSED BY APPLICABLE LAW, INCLUDING ANY IMPLIED WARRANTY OF MERCHANTABILITY OR FITNESS FOR A PARTICULAR PURPOSE, ARE LIMITED TO THE DURATION OF THE EXPRESS LIMITED WARRANTY. SOME JURISDICTIONS DO NOT ALLOW LIMITATIONS ON HOW LONG AN IMPLIED WARRANTY LASTS, SO THE ABOVE LIMITATION MAY NOT APPLY TO YOU.**

Notice: As a term of any warranties provided above, you must contact Zodiac immediately upon the happening of any event upon which you make a warranty claim. Failure to provide this prompt notice may result in your forfeiting warranty rights and claim.

## **THIS LIMITED WARRANTY EXCLUDES THE FOLLOWING:**

1. Discoloration of the X7 Quattro pool cleaner. This is caused by reaction to ultraviolet rays and the chemicals used in the pool water. Discoloration does not affect the operating ability of the X7 Quattro. Therefore, this Limited Warranty does not cover the replacement of discolored parts.
2. Damage to or malfunction of the unit resulting from excess chlorination or improper water chemistry balance.
3. Replacement of parts which fail or become defective as a result of improper installation, negligence, misuse, abuse or tampering by unauthorized repair personnel.
4. Age, pool water imbalance, and improper installation can cause vinyl pool liners to become brittle or unduly wrinkled. Corrosion of the supporting walls and/or irregularities in the pool base may also cause liner failure. The use of this product in such an environment is at the pool owner's risk. Therefore, the pool owner hereby releases the manufacturer from any and all claims for damage where these conditions exist.
5. The X7 Quattro is designed for use in in-ground pools only. If unit is used in any other application, the pool owner hereby releases the manufacturer from any and all claims. This misuse will void all warranty on the unit.
6. In no event shall Zodiac be liable in contract or in tort, or under any other legal theory, for lost profits or revenues, loss of use or similar economic loss, or for indirect, special, incidental, consequential or similar damages, even if it has been advised of the possibility of such claim. Some jurisdictions do not allow the exclusion or limitation of incidental or consequential damages, so the above limitation or exclusion may not apply to you.

## **IMPORTANT WARRANTY NOTICES FOR VINYL LINER POOL OWNERS**

- Certain vinyl liner patterns are particularly susceptible to rapid surface wear or pattern removal caused by objects coming into contact with the vinyl surface, including pool brushes, pool toys, floats, fountains, chlorine dispensers, and automatic pool cleaners. Some vinyl liner patterns can be seriously scratched or abraded simply by rubbing the surface with a pool brush. Ink from the pattern can also rub off during the installation process or when it comes into contact with objects in the pool. **Zodiac is not responsible for, and the Limited Warranty does not cover, pattern removal, abrasion or marking on vinyl liners.**
- Vinyl liners are subject to deterioration or damage due to age, the effect of chemicals, corrosion or failure of the supporting walls; as well as improper installation, maintenance or cleaning of the supporting walls or base. Before installing the X7 Quattro, examine the interior of your pool carefully. If your vinyl liner is brittle or has stones, wrinkles, roots or metal corrosion in contact with the underside of the liner, or has damage to the base material or supporting walls, do not install the X7 Quattro before having a qualified professional perform the necessary repairs or liner replacement.

**ZODIAC WILL NOT BE RESPONSIBLE FOR LINER DAMAGE CAUSED BY (1) A X7 QUATTRO CLEANER WHICH IS IN DISREPAIR, (2) PATTERN REMOVAL FROM A VINYL LINER, OR (3) A X7 QUATTRO CLEANER USED IN A POOL HAVING AN AGED OR DETERIORATED LINER.**

## **WARRANTY PROCEDURES**

No claim under this Limited Warranty will be recognized unless the registration card, included in your box, is completed and returned within thirty (30) days of the purchase date. **Only the original purchaser may submit a claim under this Limited Warranty.** Purchaser's claims against Zodiac shall be limited to those claims which may be asserted under the Limited Warranty relating to any defect or malfunction of the X7 Quattro.

To obtain warranty replacements or repair, call Zodiac for authorization. When submitting a claim, always supply the serial number, evidence of purchase date, retailer and a brief description of the problems/defects encountered. Zodiac reserves the right to repair or replace all defective parts covered by this Limited Warranty, and return same to purchaser, freight collect.

Zodiac assumes no responsibility for any warranties or representations made by other individuals or businesses beyond the express terms contained in this Limited Warranty. This warranty gives you specific legal rights, and you may also have other rights which vary from jurisdiction to jurisdiction.

For sale and use in the United States and Mexico only. This pool cleaner is not warranted or guaranteed in any other country.



**Zodiac Pool Systems, Inc.**  
2620 Commerce Way  
Vista, CA 92081 USA • Tel: 1-800-822-7933