

WATER TECH
"The pool invention people"

POOL BLASTER
iVAC®
AQUA BROOM

Operator's Manual



Water Tech Corp
10 Alvin Ct.,
East Brunswick, NJ 08816
USA

Toll Free: (800) 298-8800

info@WaterTechCorp.com
www.WaterTechCorp.com

IMPORTANT:
DO NOT RETURN THIS PRODUCT TO THE STORE

Should you have any questions or problems concerning your product please contact Water Tech's Customer Service division toll free at 1-800-298-8800 or visit www.poolblaster.com

TABLE OF CONTENTS

WARRANTY

Water Tech Corp ("WT") warrants this product, including supplied accessories against defects in material or workmanship for the time periods as set forth below. Pursuant to this Limited Warranty WT will, at its option (i) repair the product to the original specifications or (ii) replace the product with a new or refurbished product. In the event of a defect, these are your exclusive remedies. For purposes of this Limited Warranty, "refurbished," means a product or part that has been return to its original specifications.

All Pool Blaster Battery Powered Pool & Spa Vacuums. For a period of one (1) year from the original date of purchase of the product, WT will, at its option, repair or replace with new or refurbished product or parts, any product or parts determined to be defective.

Accessories. Included accessories are covered by this Limited Warranty for a period of (90) days from the original date of purchase of the product.

Instructions. Please retain the original box and internal packaging materials. To obtain warranty service, you must comply with the following requisite instructions:

(1) Visit Water Tech Corp's Customer Support Department via email at www.wtrma.com. You will be guided through the correct process on how to obtain the required

RMA# (Return Merchandise Authorization Number.) All customers must obtain an RMA number before any product will be accepted for warranty service. If you need additional assistance please contact us by telephone: (800-298-8800), email: customer.service@watertechcorp.com.

(2) Package the unit with all accessories properly and securely in the original box.

(3) Attach your RMA number and Bar-Code you received from the website to the outside of the package. If you could not print the RMA number and bar-code from the website you must write your RMA number in thick black indelible marker on two sides of the box.

(4) Send the package by USPS or express courier of choice to: Water Tech Corp. 10 Alvin Court, East Brunswick, New Jersey 08816. (WT suggests you insure the contents of your package.) WT is not responsible for lost, stolen or damaged property in transit to WT.

Repair/Replacement Warranty. This Limited Warranty shall apply to any repair, replacement part or replacement product for the remainder of the original Limited Warranty period or for ninety (90) days, whichever is longer. Any parts or products replaced shall become the property of WT.

This Limited Warranty covers only product issues caused by defects in material or workmanship during ordinary consumer use; it does not cover product issues caused by any other reasons, including but not limited to product issues caused by commercial use, acts of God, misuse, abuse, limitations in technology, or modification of or to any part of the WT product. This Limited Warranty does not cover WT products sold AS IS or WITH ALL FAULTS or consumables (such as batteries). This Limited Warranty is invalid if the factory-applied serial number has been altered or removed from the product. This Limited Warranty is valid only in the United States and Canada.

EXPRESS LIMITATION: THIS LIMITED WARRANTY ONLY APPLIES IF THE PRODUCT WAS PURCHASED FROM AN AUTHORIZED WATER TECH DEALER. THIS WARRANTY IS NOT TRANSFERABLE

LIMITATION ON DAMAGES. WT WILL NOT BE LIABLE FOR ANY INCIDENTAL OR CONSEQUENTIAL DAMAGES FOR BREACH OF EXPRESS OR IMPLIED WARRANTY ON THIS PRODUCT.

DURATION OF IMPLIED WARRANTIES. EXCEPT TO THE EXTENT PROHIBITED BY LAW APPLICABLE LAW, ANY IMPLIED WARRANTY OF MERCHANTABILITY OR FITNESS FOR A PARTICULAR PURPOSE ON THIS PRODUCT IS LIMITED IN DURATION OF THIS WARRANTY.

Some states do not allow the exclusion or limitation of incidental or consequential damages, or allow limitations on how long an implied warranty lasts, so the above limitations or exclusions may not apply to you. This Limited Warranty gives you specific legal rights and you may have other rights, which vary from state to state.

Note from Water Tech	2
Important Tips	3
Service & Important Safeguards	4
Product Specifications/Diagram	6
Setting Up Your Cleaner	7
Using Your Cleaner	8
Using a Standard Pool Pole	9
Cleaning the Filter Bag	10
Common Questions	11
Warranty	12

POOL BLASTER
iVAC®
AQUA BROOM



CONGRATULATIONS on your purchase of a top-quality Water Tech product, which has been thoroughly tested to meet our exacting quality control standards. These guidelines and safeguards help insure that your new cleaner operates effectively. Please read all instructions carefully before using your cleaner.

COMMON QUESTIONS

Q: *Can my cleaner be run out of water?*

A: Yes, for a short period of time when you turn it on before submerging into your pool or spa. We recommend you turn the cleaner on just before submerging.

Q: *When I am cleaning my pool, how do I know when the cleaner is out of battery power?*

A: Most people can feel the cleaner is running through vibration in the vacuum pole. To be sure, you can lift it out of the water to hear if it is running or not.

Q: *How often should I clean out my cleaner filter bag?*

A: It is advisable to clean out your filter bag after each use, or whenever you notice the performance of your cleaner declining. For easy cleaning, the filter bag can be turned inside out and rinsed with a hose or in a sink. Do not wash it in a washing machine or with detergent. For more detailed instructions, see "Cleaning Your cleaner" instructions in this manual.

Q: *Where can I buy replacement parts?*

A: Look for original Water Tech replacement parts at your local retailer, visit www.PoolBroom.com, or call 1-800-298-8800 for more details.

Q: *Can I leave the cleaner in the pool when not in use?*

A: No. The cleaner should be removed from the pool and stored in a clean, dry place when not in use. This will increase the life of your cleaner and its accessories.

Q: *Can I leave the batteries in the cleaner all the time?*

A: For long term storage, it is best to remove batteries from chamber. For day-to-day use, you can leave the batteries in the cleaner. It is a good idea to periodically check the battery chamber for moisture and drain/air out if necessary.

Q: *How can I prevent sand and silt from escaping through the filter bag?*

A: A fine mesh vacuum bag, part no. IVBRFM is available to purchase. Contact your retailer, visit www.PoolBroom.com, or call us at 1-800-298-8800.

Q: *What do I do if my cleaner does not vacuum?*

A: Make sure your cleaner is completely submerged in the water. The cleaner is only designed to vacuum water and will not vacuum air.

Check the following:

Make sure the filter bag and head cover are clear of debris that may be obstructing water flow.

Make sure the cleaner is turned on.

If none of the above help resolve the situation, please call our Customer Service Division at 1-800-298-8800.

CLEANING THE REUSABLE FILTER BAG

For maximum cleaning efficiency, the filter bag/seal ring should be checked, emptied and cleaned after each use or whenever you notice the performance of your cleaner declining.

To clean the filter bag

Make sure the unit is off before changing the filter or performing any other routine maintenance.

Remove the filter bag/seal by pulling firmly on the head cover

Invert the filter bag and rinse it with a garden hose or in a sink. Note: DO NOT clean in a washing machine or with detergent.

Re-insert the filter bag when finished and reattach head cover.

Note: Your reusable filter bag should be replaced if the seal ring is worn or if the bag is torn

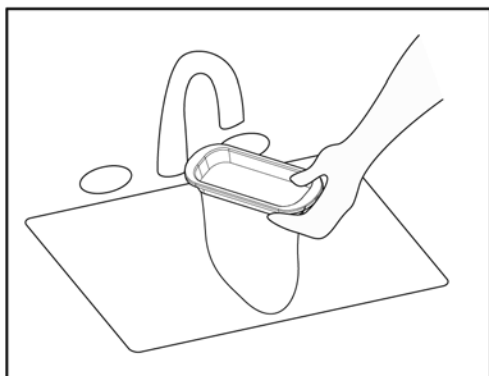

⚠ WARNING: Using your cleaner without the filter bag/seal in place will cause blockages in your machine and void your warranty.

⚠ WARNING: When servicing user serviceable parts, use only identical Water Tech replacement parts. Use of any other parts may create a hazard or cause product damage.

IMPORTANT TIPS

NOTE: When not in use, your cleaner should be stored **indoors**, in a clean dry location sheltered from direct sunlight, extreme temperatures, and rain. Do not store the cleaner in a garage or anywhere the unit could freeze.

You may clean the cleaner body with soap and water. Avoid using solvents when cleaning plastic parts. Most plastics are susceptible to damage from various types of commercial solvents and may be damaged by their use. Use a clean cloth to remove dirt, dust, oil, grease, etc.

General maintenance of your cleaner requires you to occasionally clean off the O-rings on the head and add non-curing, non-toxic, high-temp, silicon lubricant/sealant, such as Dow Corning 111. This will ensure easier turning and a watertight seal. You can order lubricant directly from Water Tech (Part No. PBLUBE) or at your local pool & spa retailer.

⚠ CAUTION

Do not at any time let brake fluids, gasoline, petroleum-based products, penetrating oils, etc. come into contact with plastic parts. They contain chemicals that can damage, weaken or destroy plastic.

⚠ WARNING

Do not attempt to modify this tool or create accessories not approved for use with this tool. Any such alteration or modification is misuse and could result in a hazardous condition leading to possible serious injury. The motor is factory sealed in the motor box and **CANNOT BE REPLACED**. Do not attempt in any way to destroy or disassemble motor box or any of its components. Instead, take your cleaner to an authorized service center. Failure to follow these instructions may void your warranty agreement.

SERVICE INFORMATION

NOTE: Any repairs requiring disassembly must be performed by a Water Tech Authorized Service Center. For the repair center nearest you, go to www.poolblaster.com or call us toll free at 1-800-298-8800. Unauthorized repairs will void the warranty.











SERVICE & IMPORTANT SAFEGUARDS

WARNING:

Any repairs requiring disassembly must be performed by a Water Tech Authorized Service Center. For the repair center nearest you, go to www.poolblaster.com or call us toll free at 1-800-298-8800. Unauthorized repairs will void the warranty.

WARNING:

To reduce the risk of fire, electrical shock, injury or damage to your machine:

-  Opening the motor box exposes the motor components. Never let water enter here, as this will ruin your appliance and void the warranty.
-  Keep away from children.
-  Failure to comply with these warnings could result in fire and/or serious injury.
-  Do not use if unit is damaged in any way.
-  Use this product only for its intended use as described in this manual. Use only Water Tech accessories and filters.
-  **NEVER LEAVE YOUR POOL BROOM IN WATER WHEN IT IS OFF OR HAS RUN OUT OF BATTERY POWER.**
-  Do not use your cleaner for pool openings; the cleaner is designed for general maintenance of your pool or spa.
-  The cleaner is designed for underwater use only. Do not attempt to use your cleaner to clean anything other than your pool or spa. It is not intended for use as an all-purpose vacuum cleaner.
-  Close supervision is necessary when used near children. Do not allow this vacuum cleaner to be used as a toy.
-  This vacuum creates suction. Keep hair, loose clothing, fingers, and all parts of body away from openings and moving parts.

ATTACHING A STANDARD POOL POLE

The handle on your cleaner is designed to accommodate any standard pole. Small poles (1" diameter) can be attached directly to the pool broom. If your pole has a larger (1 1/4") diameter, use the pole adapter included with your cleaner.

To attach a pole, simply press down on the alignment pins. Aligning the holes, slide the pole through the cuff, onto the cleaner, and release the clip.

WARNING: DO NOT LEAN ON POLE OR USE POLE TO SUPPORT WEIGHT

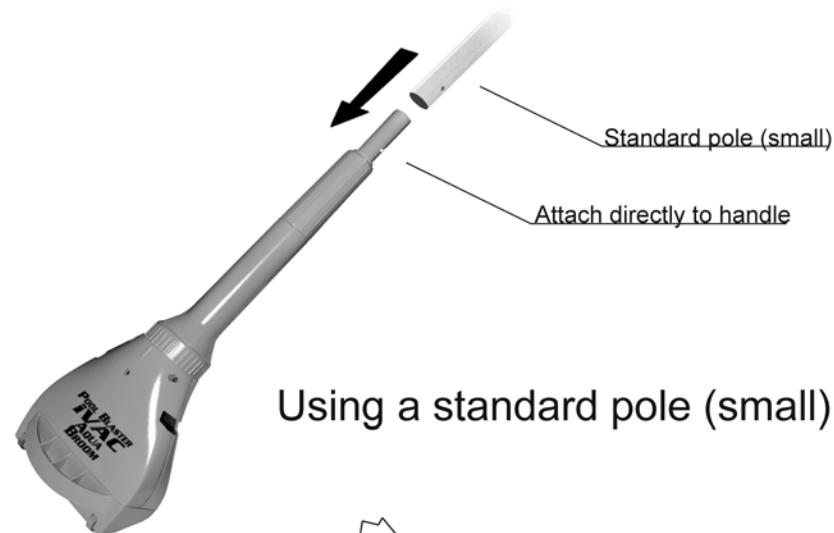

Using a standard pole (small)

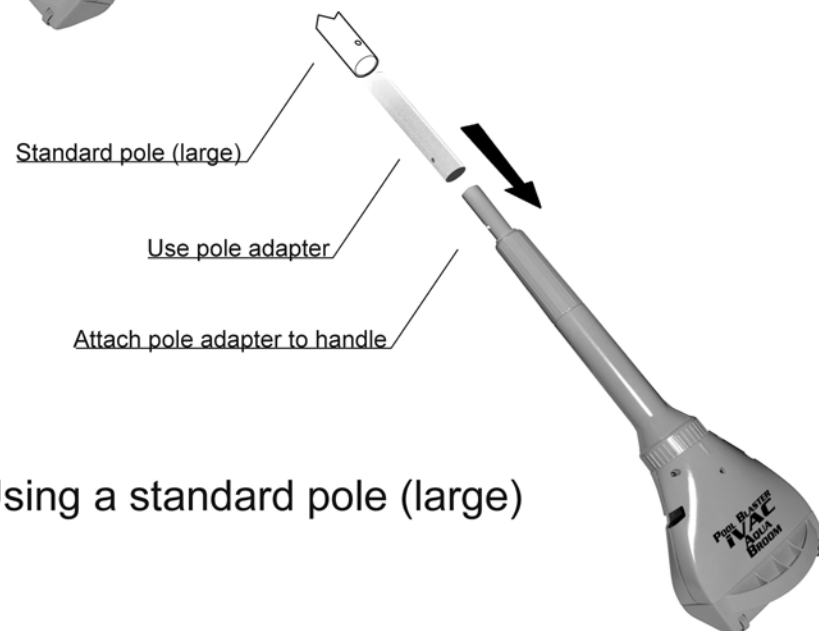

Using a standard pole (large)

USING YOUR CLEANER

The Pool/Spa Cleaner is designed for general cleaning in all types of pools and spas. Use with caution for heavy cleaning - do not attempt to vacuum up large or sharp objects. The removable filter bag should be inspected and cleaned after each use.

Bring your cleaner to the side of the pool or spa and turn it on. The Pool/Spa Cleaner is in the "on" position when the head is rotated fully and the two indicator lines on the head and neck match up. **This must be done outside of the water before it is submerged.** Once the cleaner is on it can be completely submerged in water and is ready for use.

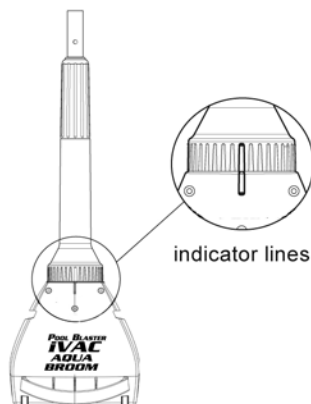

It is very important to make sure the unit is sealed and in the on position before submerging. **Do not submerge the unit until indicator lines meet.** Your cleaner should never be left in the water when off, as leakage can occur.

NOTE: The cleaner is only designed to vacuum water and will not vacuum air. The cleaner will only work when completely submerged in water.

STORAGE:

A certain amount of space is left open in the Pool/Spa Cleaner body in order to ventilate and cool the motor and batteries. From time to time, water may enter the unit. It is very important to drain the unit completely between uses.

To store the Pool/Spa Cleaner, remove power head from battery chamber. Invert battery chamber to make sure any water in chamber is drained. (Hold batteries in place with your thumb so they don't fall out.) Leave power head and battery chamber separated until next use. For best care, remove batteries from chamber after each use.

PRECAUTIONS

- ⚠ Unit must be submerged in water to operate properly.
- ⚠ When not in use, store the Pool Broom **indoors**, in a clean, dry place. Do not leave underwater, in direct sunlight, or exposed to extreme temperatures.
- ⚠ For long term storage, remove batteries from your Pool Broom. Never leave batteries in Pool Broom for extended periods.
- ⚠ Do not use without vacuum bag and head cover in place.
- ⚠ Replace damaged filter bags promptly.
- ⚠ Avoid picking up hard, sharp objects with the vacuum. They may damage the vacuum and the filter bag.
- ⚠ Do not use to pick up toxic substances, flammable or combustible liquids such as gasoline, or operate in the presence of explosive or flammable fumes.
- ⚠ Never insert or drop any object into any opening on the device. Keep all openings free of leaves, rocks or anything that may reduce water flow.
- ⚠ Use extra care when cleaning on stairs.
- ⚠ Make sure the Pool Broom is in the 'off' position before cleaning or any other routine maintenance.
- ⚠ If vacuum cleaner is not working as it should, or has been dropped or damaged in any way, return it to a service center before using. Call 1-800-298-8800 or visit www.poolblaster.com for a center nearest you.
- ⚠ Leaks from a battery cell can occur under extreme conditions. If the battery liquid gets on the skin, wash immediately with water. If it gets in your eyes, immediately flush your eyes with a mild solution of baking soda and water and seek medical attention.

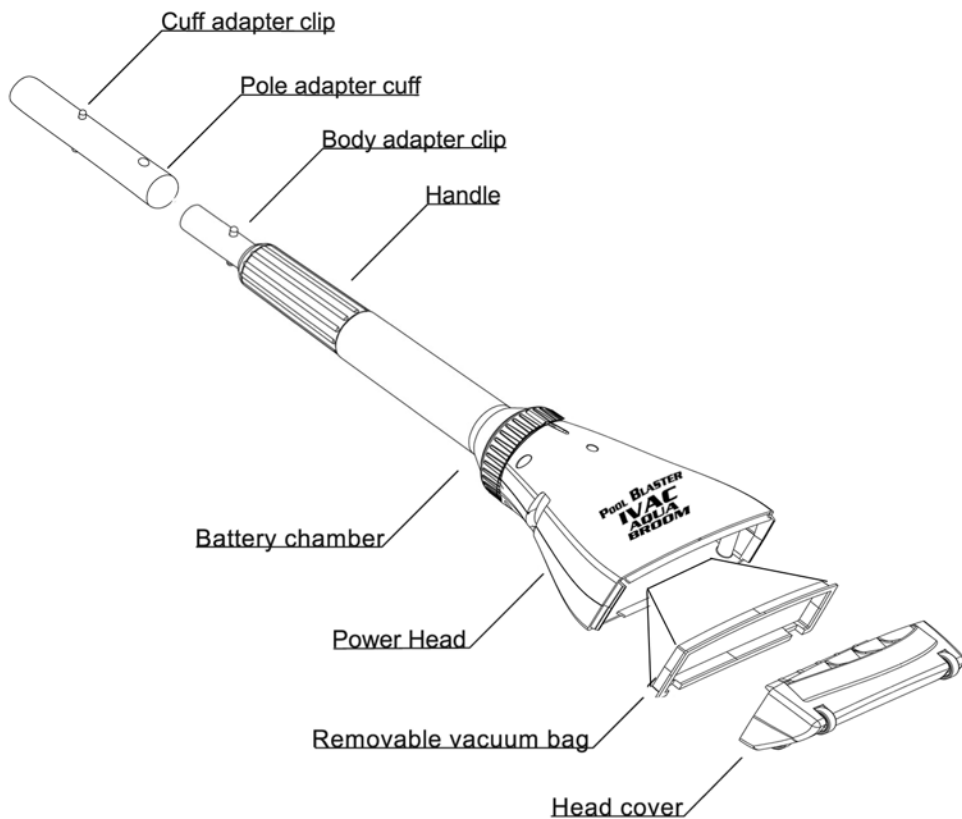

PRODUCT SPECIFICATIONS

ITEM NO.	DESCRIPTION	QTY.
IVBRHC	HEAD COVER	1
IVAB022AP	ALL PURPOSE FILTER	1
BRHD	POWER HEAD	1
BRBC	BATTERY CHAMBER	1
BRBAC	SPRING CLIP / BATTERY CHAMBER	1
BRPAC	SPRING CLIP / POLE ADAPTER	1
BRPACF	POLE ADAPTER CUFF	1
IVAB022MF	MICRO FILTER	2

ADDITIONAL AVAILABLE PARTS

Fine mesh vacuum bag, Part No.IVBRFM is available. To purchase, contact your retailer, visit www.poolblaster.com, or call us toll free at 1-800-298-8800.

SETTING UP YOUR CLEANER FOR USE

Your Pool/Spa Cleaner uses five D size batteries. To insert batteries, turn cleaner upside down. Remove head by gripping and turning counterclockwise. Insert batteries, **positive ends facing up** (towards head). Replace head on battery chamber and turn clockwise.

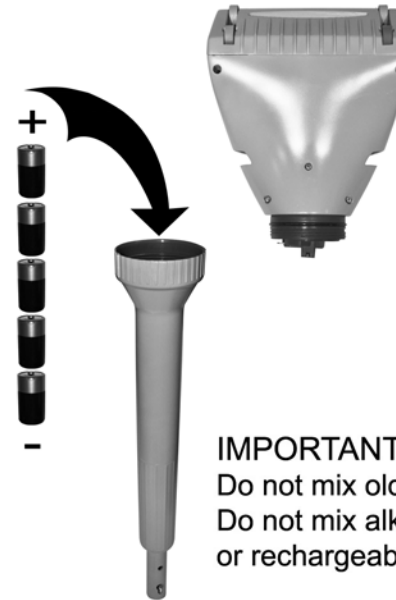

IMPORTANT:

Do not mix old and new batteries.
Do not mix alkaline, standard (Carbon-zinc) or rechargeable (Nickel-cadmium) batteries.

Check tightness of head cover and filter bag/seal. You are now ready to use the Pool/Spa cleaner in your pool or spa.

