

# PAL-Treo

**T**otally **f**etrofitable **e**ven Glow LED Technology **o**ptics

After listening to what the industry had to say about LED pool lighting systems, we found what was important and built all of these features into our new **PAL-Treo** LED light.



- + *Fits in standard wall fittings*
- + *Totally serviceable*
- + *Replacable LED lamp*
- + *Wide beam spread*
- + *New - Brighter LED lamp*
- + *Self synchronized*
- + *Excellent for Retrofit projects*  
Will retrofit most existing fiber installations

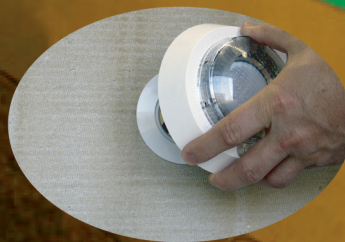

**G**unite - **f**iberglass - **V**inyl - **A**ny Pool, **A**ny Time



Fiberstars 6678 Owens Drive Suite 105 Pleasanton, CA 94588  
T (888) 704-2276 F (888) 704-2292 W [fiberstars.com](http://fiberstars.com)

# PAL-Treo

**T**otally **f**etrofitable **e**ven Glow LED Technology **o**ptics

## PAL-Treo LED Underwater light system and accessories

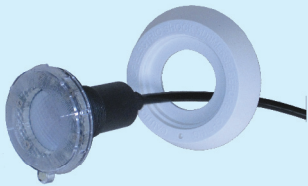

### FPAL-C-TR

12VAC, 5 watt complete underwater LED light assembly w/ 79' of low voltage cord. Fits in most 1.5" wall fittings and only requires 2.75" of 1.5" of straight conduit behind fitting. 100,000 hour LED color array is self synchronizing with other Treo's. Choice of six lockable colors and two color change modes.

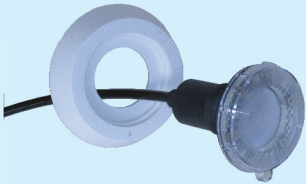

### FPAL-C-TR-150

Same as the standard PAL-Treo listed above but equipped with 150' of low voltage cord for those longer conduit runs.

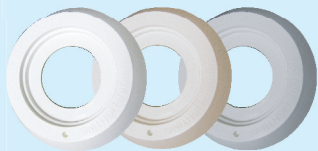

**FPAL-TRW-TR** (*white - as originally equipped*)

**FPAL-TRT-TR** (*tan - optional color, purchase separately*)

**FPAL-TRG-TR** (*grey - optional color, purchase separately*)

Treo specific trim / UL warning ring molded in listed color. Purchase separately as replacement or color match part.

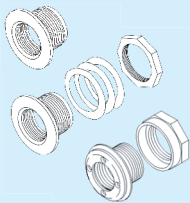

**LNS-2G** *Gunitite wall fitting, glues to 1.5" PVC*

**LNS-2A** *Fiberglass wall fitting, glues to 1.5" PVC*

**LNS-2V** *Vinyl wall fitting, threads to 1.5" PVC MIP*

Standard 1.5" wall fittings to be used with PAL-Treo lights as well as various fiber light lenses.



**FPAL-LAU** *12VAC, 5 watt replacement lamp for PAL-Treo*

Color changing LED array is self synchronizing, provides two color changing and six lockable color modes *plus* 3 start modes. 100,000 hour average lamp life.

The new PAL-Treo will color synchronize with the upcoming 2010 *Light Streams series of water features* and becomes a key product in the growing family of 12VAC products by Fiberstars. This family of high performance, low power consumption lighting products can be wirelessly controlled by the WPC 12V Power Centers that include the **WIRTRAN**, **WPC1-xxxx-T**, **WPC2-xxxx-T**, and an exciting new 'to be announced' retrofit product - stay tuned to see what comes next from The New Fiberstars.

**G**unitite - **f**iberglass - **V**inyl - **A**ny Pool, **A**ny Time



Fiberstars 6678 Owens Drive Suite 105 Pleasanton, CA 94588

T (888) 704-2276

F (888) 704-2292

W [fiberstars.com](http://fiberstars.com)