

## DURO-SPRING BASE:



### FEATURES:

- Active Base - Spring Feature is Derived from Base
- Powder Coated Steel Base
- Available for Use With 6' & 8' Length Boards
- 3 Hole Drill Pattern
- Refer to Board Chart on Pg. 7
- Refer to Available Base Colors on Pg. 7

Part # DSS6 (Duro-Spring base, 6' jig & hardware)  
 Part # DSS8 (Duro-Spring base, 8' jig & hardware)

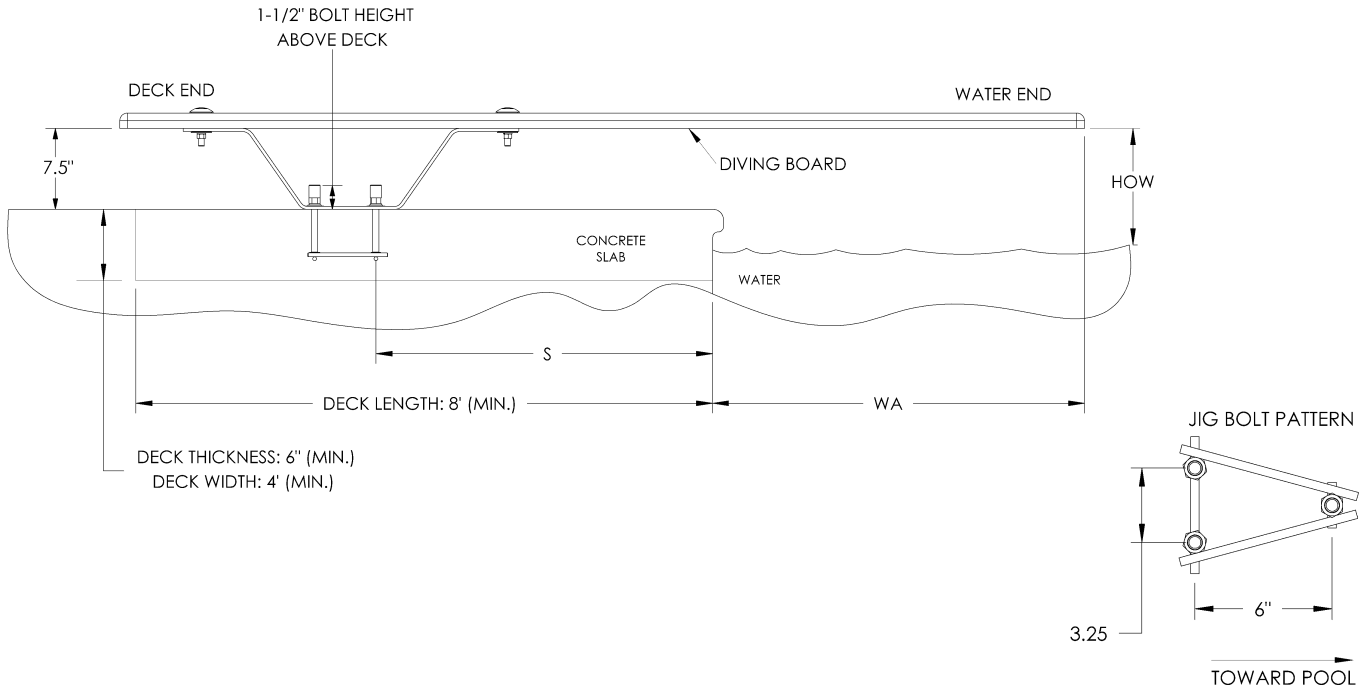

IMPORTANT: THESE DIMENSIONS ARE ACCURATE ONLY FOR VERTICAL POOL WALLS, <b>TYPICALLY GUNITE CONSTRUCTION</b> , WITH LESS THAN A 3' RADIUS TO THE POOL FLOOR.  DUE TO THE VARYING SIZES OF OTHER POOLS, <b>TYPICALLY VINYL LINER CONSTRUCTION</b> . PLEASE CONTACT CUSTOMER SERVICE FOR PROPER JIG PLACEMENT.  <b>1-800-737-5386</b>	DURO-SPRING PART #	NOMINAL BOARD LENGTH	ANSI/NSPI-5 POOL TYPE	DISTANCE FROM WATER'S EDGE TO FORWARD JIG BOLT (S)	DISTANCE FROM END OF BOARD TO FORWARD JIG BOLT	MIN. OVERHANG PLUS OR MINUS 3" (WA)	MAX HEIGHT OF BOARD ABOVE WATER (HOW)
		DSS6	6'	I	27"	45"	18"
	DSS6	6'	II	27"	45"	18"	20"
	DSS6	6'	III	21"	45"	24"	26"
	DSS6	6'	IV	15"	45"	30"	30"
	DSS6	6'	V	9"	45"	36"	40"
	DSS8	8'	I	Cannot put 8' jump board on type I pool			
	DSS8	8'	II	Cannot put 8' jump board on type II pool			
	DSS8	8'	III	39.75"	63.75"	24"	26"
	DSS8	8'	IV	33.75"	63.75"	30"	30"
	DSS8	8'	V	27.75"	63.75"	36"	40"

**DURO-SPRING BASE (DSS6):**

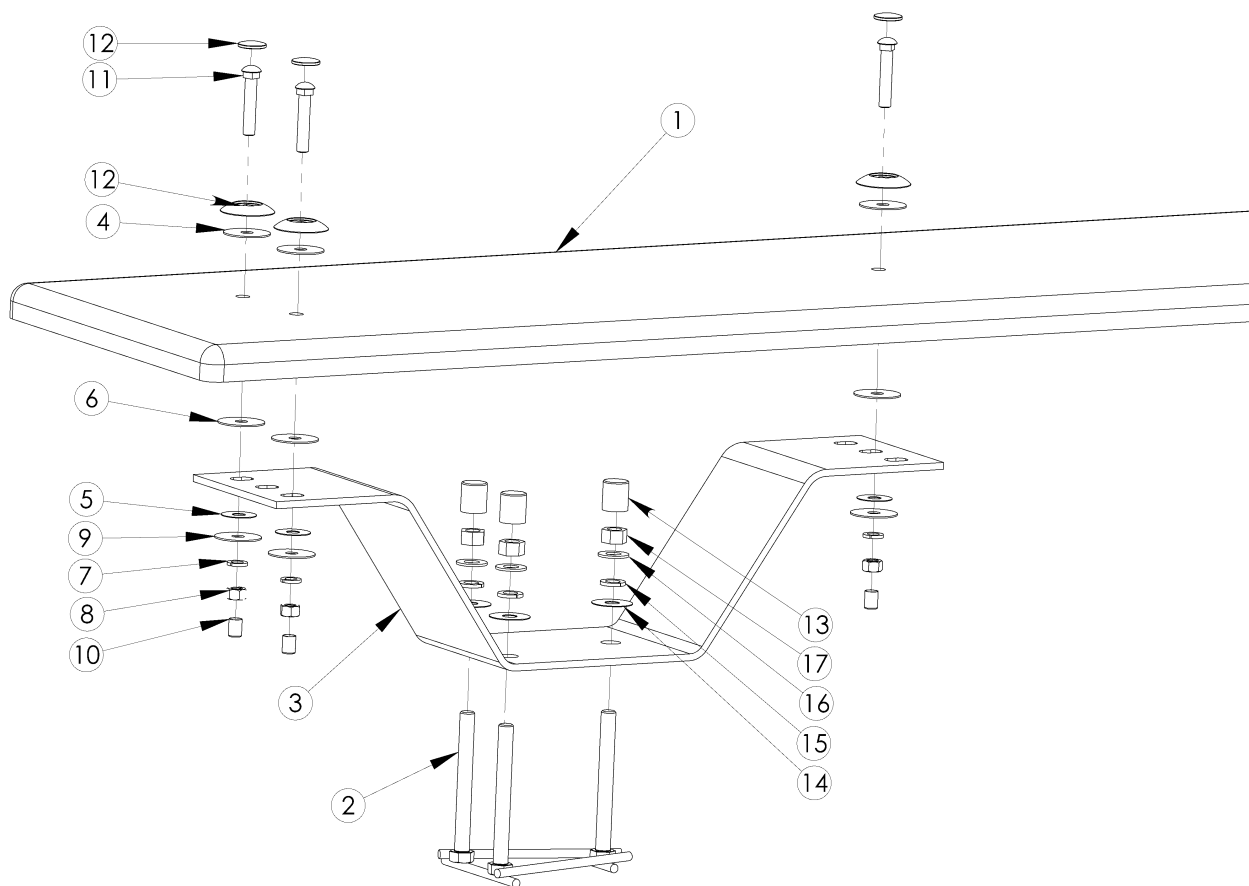

**DRAWING REPRESENTS THE FOLLOWING PART NUMBERS:**

DSS6 (shown)
DSS8

ITEM #	COMPONENT	DESCRIPTION	KITS – QTY. COUNTS		
			DS-M	DS-BK	N/A
1	DS6WW	6' Duro-Spring White w/ White Top Tread & Hdw Kit			1
2	DS-J	Duro-Spring Mounting Jig			1
3	DSS6	6' Duro-Spring Jump Stand			1
4	H-1/2 BLK WASH	1/2 x 2" Black Rubber Washer	3		
5	H-1/2 NYLON WAS	1/2" Flat Washer Nylon	3		
6	H-1/2 RED WASH	1/2 x 2" Red Rubber Washer	3		
7	H-SS 1/2 LOC WA	1/2 Lock Washer S.S.	3		
8	H-SS 1/2 H NUT	1/2"- 13 Hex Finish Nut S.S.	3		
9	H-SS 1/2 F WAS	1/2 USS Flat Washer S.S.	3		
10	H-1-1/2 WHT CAP	.750 x 1-1/2 White UV Nut Cap	3		
11	H-SS 3 C BOLT	1/2-13 x 3" Carriage Bolt S.S.	3		
12	H-WHT WAS/CAP	I.F. White Washer/Cap	3		
13	H-1x1-1/2 W CAP	1" I.D.x 1-1/2" Long White UV		3	
14	H-5/8 RD WASH	5/8 x 1-3/4" Round Nylon Washer		3	
15	H-SS 5/8 F WASH	5/8" USS Flat Washer S.S.		3	
16	H-SS 5/8 LOC WAS	5/8 Split Lock Washer S.S.		3	
17	H-SS 5/8 H NUT	5/8-11 Hex Finish Nut S.S.		3	

**NOTES:**

DSS6 diving board shown in exploded view for illustration purposes. Must be purchased separately.