

5 Start Cleaning

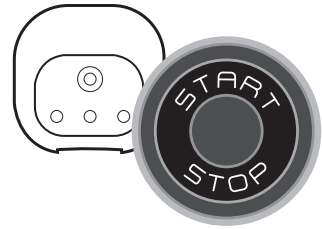

Press the Start/Stop button to begin cleaning.



Read the complete manual for additional information.



QUICK START GUIDE

6 Proper Removal from the Pool

a)

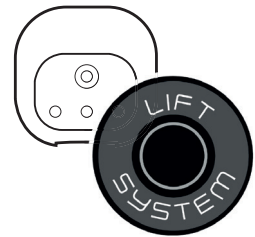

Activate the Lift System.

b)



Remove the cleaner from the pool using the handle. **Never lift the cleaner out of the pool by the floating cable.**

c)

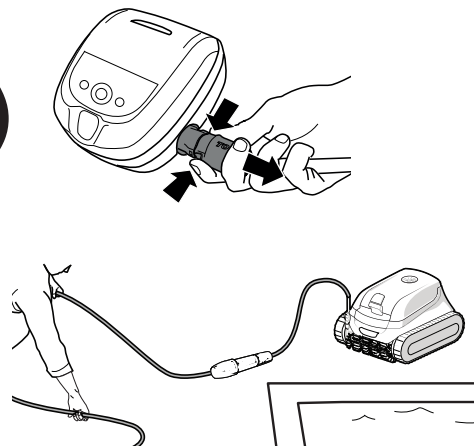

Unplug & Untangle.

d)

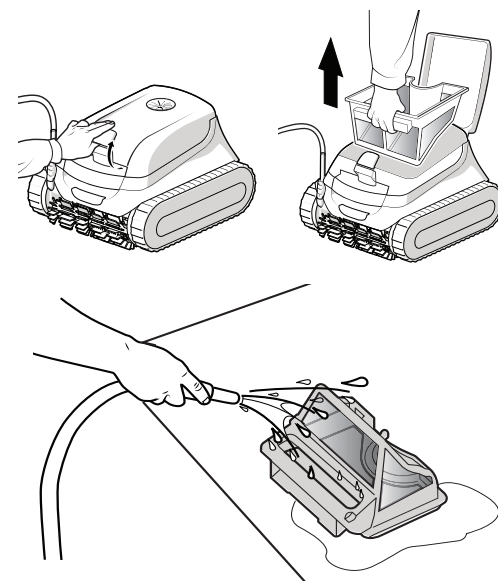

Clean the Filter Canister.

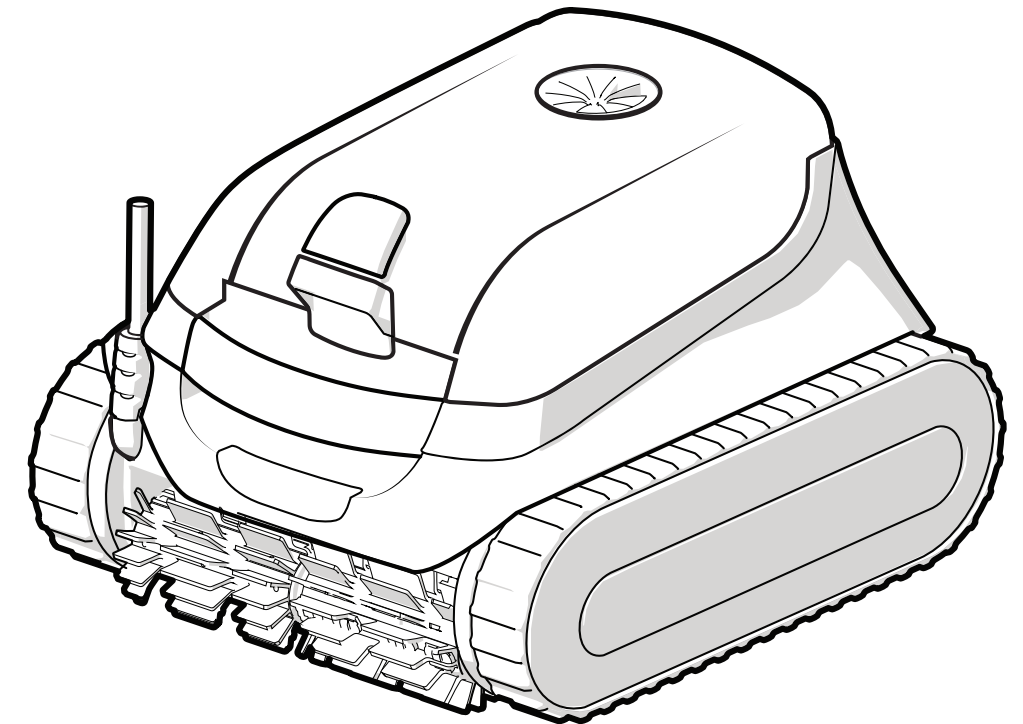

TYPE EN27--
TYPE EN37--



www.jacuzzi.com

© 2020 Jacuzzi Inc. All rights reserved.

Jacuzzi® is a registered trademark of Jacuzzi Inc. All other brands, product names, company names, trade names and trademarks used are the property of their respective owners. Jacuzzi may add to change or remove any part of these materials at any time, without notice. Reproduction in whole or in part without written permission is prohibited. International products may be configured differently to meet local electrical requirements. Dimensions are approximate.

H0722100_REVA



This Quick Start Guide contains essential installation and startup instructions. For additional operation, maintenance and troubleshooting instructions, please refer to the complete Owner's Manual. Read the complete manual and all safety warnings before commencing installation.

www.jacuzzi.com

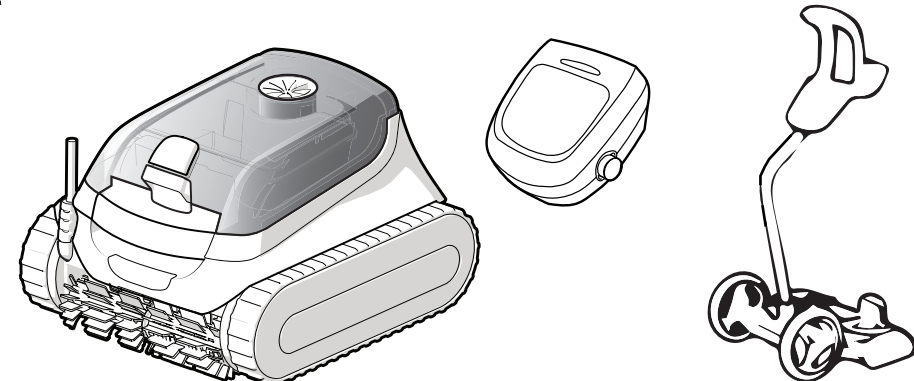
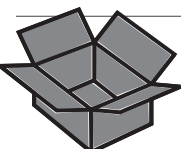

full caddy assembly instructions found separately

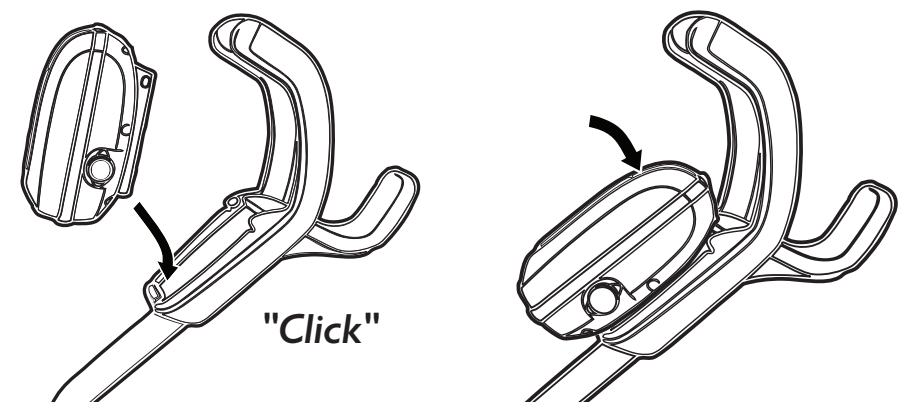

2 Connect Floating Cable



- Never turn on the cleaner unless it is fully submerged in the water. Doing so will void the warranty and may cause severe damage to the cleaner motors.
- Do not use an extension cord to connect the control unit.
- Ensure that children do not attempt to access the cleaner while in operation.

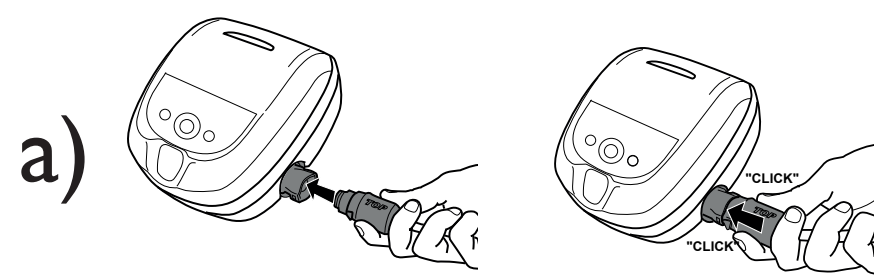

3 Submerge Cleaner in Pool



Never swim with the cleaner in the pool.

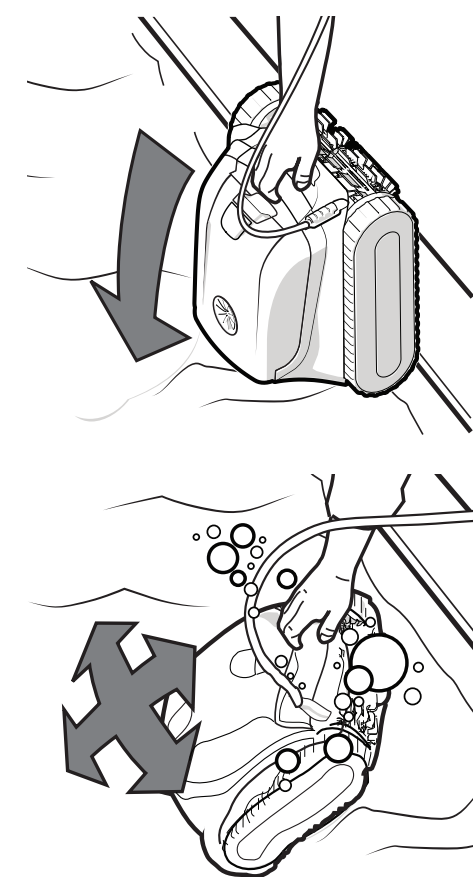

a) Hold the handle and submerge in pool

b) Wait for bubbles to stop completely, then let the cleaner sink to the bottom of the pool.

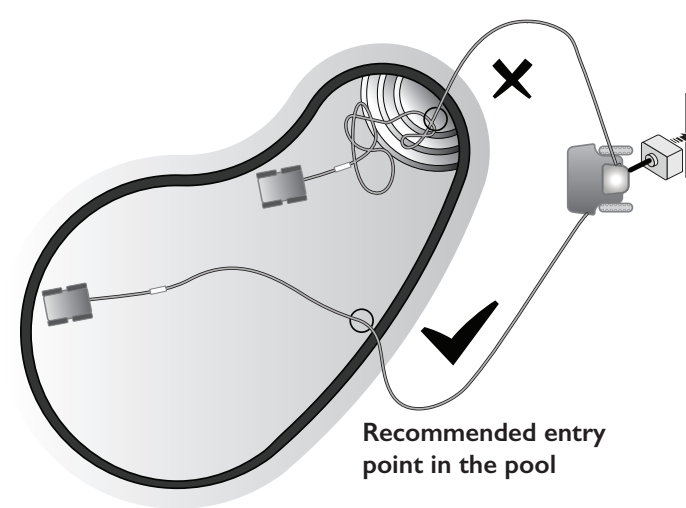

c) For optimal patterning and reduced cord tangling, submerge the cleaner at the recommended entry point in the pool.

Spread all of the length of cable out over the pool to avoid tangling and ensure adequate coverage.

4 Control Box Buttons



Start/Stop cleaning



Select cleaning mode



Remove cleaner from the pool