

## Corded Robotic Pool Cleaner

Models: ERA™ 842  
ERA 820

TYPE EN27--  
TYPE EN37--

### **WARNING**

**FOR YOUR SAFETY** – For anything other than the routine cleaning and maintenance described in this owner's manual, this product must be serviced by a qualified professional with sufficient experience in pool equipment installation and maintenance so that all of the instructions in the product's complete owner's manual can be followed exactly. All safety instructions must be followed explicitly in order to prevent injury hazards. Never turn the cleaner on unless it is fully submerged in the water. Improper installation and/or operation may void the warranty. The owner/operator of this equipment should keep this document.

 **BEFORE YOU START** – This Owner's Manual contains essential operation and start-up instructions. Read complete manuals and all safety warnings accompanying this system before commencing operation or start-up. Visit [polarispool.com](http://polarispool.com) or call (800) 822-7933 for additional copies of all instructions.



# Table of Contents

<b>Section 1. Cleaner Specifications and Overview</b> .....	<b>3</b>	Cleaning Time from App.....	6
1.1 Technical Specifications.....	3	3.5 Using Remote Control in App.....	6
1.2 Product Overview and Contents.....	3	3.6 Initiating Lift System from the App.....	6
1.3 Usage Guidelines.....	3	3.7 In-App Error Message and Troubleshooting.....	7
<b>Section 2. Product Usage</b> .....	<b>4</b>	3.8 System Settings.....	7
2.1 Connect the Control Box.....	4	<b>Section 4. Storage Guidelines</b> .....	<b>7</b>
2.2 Install and Submerge the Cleaner.....	4	<b>Section 5. Maintenance</b> .....	<b>7</b>
2.3 Control Box Functions.....	5	5.1 Cleaning the Cleaner.....	7
2.4 Start / Stop Cleaning and Select Cleaning Mode.....	5	5.2 Cord Tangling.....	7
2.5 Manual Pool Removal.....	5	5.3 Cleaning the Filter Canister.....	8
2.6 Lift System Removal.....	5	5.4 Cleaning the Impeller Area.....	8
<b>Section 3. Using the iAquaLink® App (connected models only)</b> .....	<b>6</b>	5.5 Replacing the Brushes.....	9
3.1 Installing iAquaLink.....	6	5.6 Replacing Tracks.....	10
3.2 Connect your Cleaner to iAquaLink.....	6	<b>Section 6. Troubleshooting</b> .....	<b>11</b>
3.3 iAquaLink Control Home Screen.....	6	6.1 Error Codes.....	11
3.4 Start / Stop Cleaning and Adjust.....	6	6.2 General Troubleshooting.....	12
		6.3 iAquaLink Troubleshooting (not available on all models).....	13

THANK YOU FOR PURCHASING THIS POLARIS CLEANER.

YOUR POLARIS ROBOTIC CLEANER HAS BEEN DESIGNED AND MANUFACTURED TO BE EASILY INSTALLED AND TO PROVIDE LOW MAINTENANCE OPERATION. PRIOR TO INSTALLING, PLEASE DO THE FOLLOWING:

- 1) Complete the warranty registration card.
- 2) Record your purchase information below.
- 3) Attach your invoice (or a copy) to this page.

Taking these steps will help ensure prompt warranty service, should it be required. If service is required, please contact your original dealer. If the original dealer does not perform warranty service, please visit [polarispool.com](http://polarispool.com) to locate an independent service company near you. If you are unable to locate a service company, please call our Technical Support department at 1.800.822.7933.

Date of Purchase \_\_\_\_\_ Purchased From \_\_\_\_\_ Serial Number \_\_\_\_\_  
 (located on robot head)

City \_\_\_\_\_ State/Province \_\_\_\_\_ Zip/Postal Code \_\_\_\_\_

SCAN TO REGISTER YOUR PRODUCT:



## Section 1. Cleaner Specifications and Overview

### 1.1 Technical Specifications

	ERA™ 820	ERA 842
Control Box Power Supply	100-240 VAC, 50/60Hz. Class II*	
Cleaner Power Supply Voltage	30 VDC	
Maximum Power Input	150 W	
Floating Cable Length	60 ft (18 m)	
Cleaner Size (L x W x H)	16 x 16.4 x 11 in (40.6 x 42 x 28 cm)	
Cleaner Weight	18 lbs. (8 kg)	
Packed Weight	36 lbs. (16.3 kg)	
Water Temperature Range	Min: 55°F (13°C) Max: 95°F (35°C)	
Operating Depth Range	Min: 15 in (40 cm) Max: 13 ft (4 m)	
Control Box Rating	IP45	
Cleaner Rating	IPX8	
Frequency Bands	N/A	2.402GHz - 2.484GHz
Radiofrequency Emission	N/A	+20dBm

\*Class II: appliance with double insulation or reinforced insulation that does not require grounding.

### 1.2 Product Overview and Contents

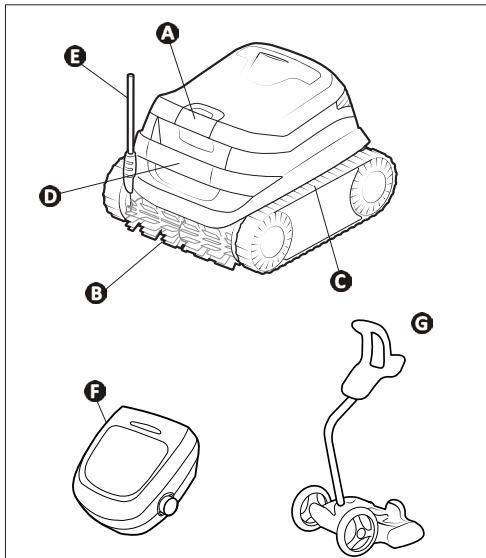

- A. Lid Latch and Filter Access
- B. Brush
- C. Tracks
- D. Handle
- E. Floating Cable
- F. Control Box
- G. Transport Caddy\*

\*assembly instructions found separately

### 1.3 Usage Guidelines

- DO NOT USE AN EXTENSION CORD TO CONNECT THE UNIT TO ELECTRIC SUPPLY; PROVIDE A PROPERLY LOCATED GFCI RECEPTACLE. THE CONTROL BOX SHOULD BE PLUGGED INTO THE GFCI RECEPTACLE BOX.
- The cleaner must be installed and operated as specified. See safety and warning manual for more information.
- This product is intended for use with permanently-installed pools. Do not use with storable pools. A permanently-installed pool is constructed in or on the ground or in a building such that it cannot be readily disassembled for storage. A storable pool is constructed so that it is capable of being readily disassembled for storage and reassembled to its original integrity.
- Clean the filter canister after each use.
- Do not use the product in your pool if the water temperature is above 95°F (35°C) or below 55°F (13°C).
- Certain vinyl liner patterns are particularly susceptible to rapid surface wear or pattern removal caused by objects coming into contact with the vinyl surface, including pool brushes, pool toys, floats, fountains, chlorine dispensers, and automatic pool cleaners. Some vinyl liner patterns can be seriously scratched or abraded simply by rubbing the surface with a pool brush. Ink from the pattern can also rub off during the installation process or when it comes into contact with objects in the pool. Fluidra is not responsible for, and the Limited Warranty does not cover, pattern removal, abrasion or markings on vinyl liners.

## Section 2. Product Usage

### 2.1 Connect the Control Box

#### **⚠ WARNING**

Failure to comply with the following warnings can result in permanent injury, electrocution or drowning.

#### **PREVENT ELECTRICAL SHOCK AND FIRE**

- **U.S.:** Per NEC® requirements, keep the control box at least five (5) ft. (1.5 m) from the edge of the pool.
- **CANADA:** Per CEC requirements, keep the control box at least three (3) m (10 ft.) from the edge of the pool.
- Only connect the control box to a receptacle protected by a ground fault circuit interrupter (GFCI). Contact a certified electrician if you cannot verify that the receptacle is protected by a GFCI.
- Do not use an extension cord to connect the control box.

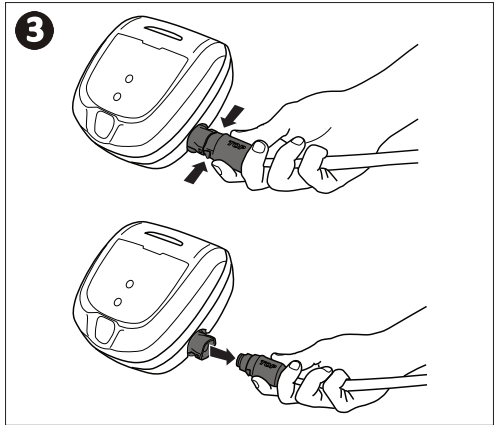
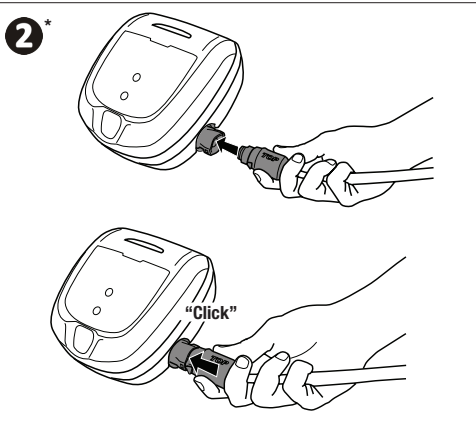
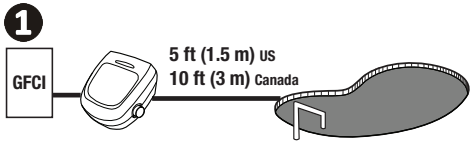



\*Connector is keyed; do not force.

### 2.2 Install and Submerge the Cleaner

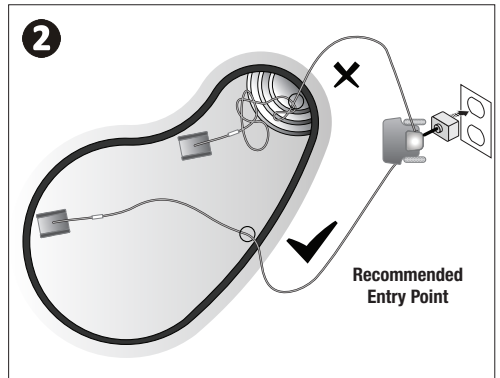
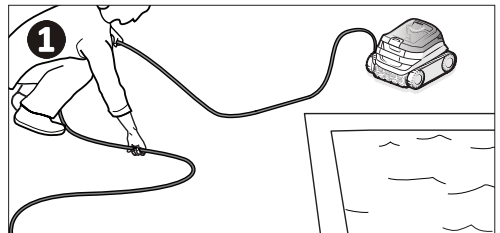
- Prepare the cable by unrolling to prevent tangles (see **1**).
- Position yourself halfway along the length of the pool before submerging the cleaner (see **2**). This will optimize the cleaner's movement and reduce cable tangling.
- Place the cleaner vertically into the water (see **3**).
- Shake it slightly to release air bubbles (see **4**).
- Allow it to sink to the bottom of the pool. Place only enough cable in the water to reach the farthest end of the pool.

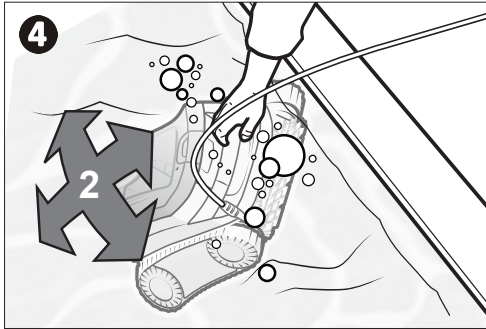
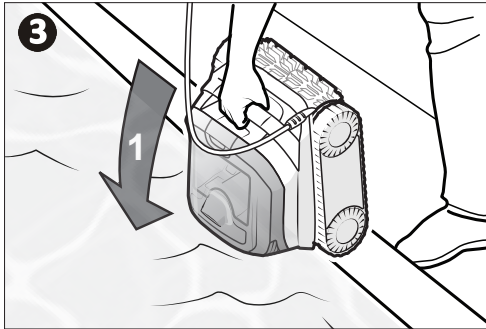



- With cleaner submerged in water, press  to begin operation. Press again to interrupt and cancel an in-progress cleaning cycle.

\*not available on all models





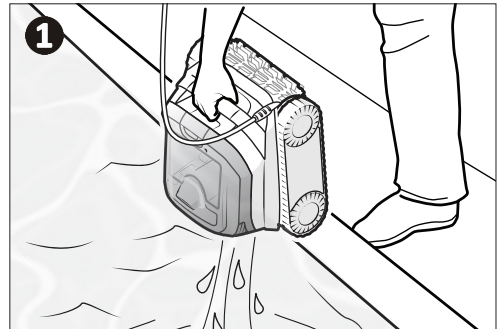

**NOTE:** The robotic cleaner has a safety feature that stops it if a cleaning cycle starts without being submerged. For pools with a beach or shallow area, it will try to reverse and return to the pool when the impeller is out of the water.

### 2.5 Manual Pool Removal

- When cleaning cycle ends, always remove the cleaner from the pool.
- Gently pull the floating cable to bring the cleaner within arm's reach.
- Use the handle to lift the cleaner out of the water. Never lift the cleaner out of the pool by the floating cable (see **1**).
- Hold the cleaner vertically over the pool surface to drain water before removing.





### 2.3 Control Box Functions

Symbol	Description	ERA 842	ERA 820
	Start / Stop cleaner	<input checked="" type="checkbox"/>	<input checked="" type="checkbox"/>
	Initiate connection and set up iAquaLink® control	<input checked="" type="checkbox"/>	
	Lift System for removal	<input checked="" type="checkbox"/>	
	Choose a cleaning mode	<input checked="" type="checkbox"/>	
	Floor Mode	<input checked="" type="checkbox"/>	
	Floor, Wall, Waterline Mode	<input checked="" type="checkbox"/>	Preset

### 2.4 Start / Stop Cleaning and Select Cleaning Mode

The factory default cleaning modes is set to Floor, Wall, Waterline.

- Use  to change the cleaning surface setting.\*
- Toggle between modes:
  -  Floor only
  -  Floor, Wall, Waterline

### 2.6 Lift System Removal

On certain models, use Lift System to easily retrieve the robot from the pool. Lift System can be activated at any time during or after a cleaning cycle.

- Press any button to engage cleaner controls.
- Press  to begin the process.

**NOTE:** To stop the procedure at any time, press and release the button again.

- Next, Press and HOLD  to rotate the cleaner.
- Once the cleaner faces the wall of your choice, release the button.
- The cleaner will drive up the wall it is facing and wait at the waterline to be retrieved.
- Remove the cleaner from the pool using the handle. The cleaner will quickly expel water to allow for lighter, easier removal.

**NOTE:** Never lift the cleaner of the pool by the floating cable.

## Section 3. Using the iAquaLink® App (connected models only)



### 3.1 Installing iAquaLink

Download iAquaLink from the App Store or Google Play to connect your cleaner for anytime, anywhere control. App features are dependent on model and imagery is subject to change.

**Before installing iAquaLink, make sure you have the following:**

- Robotic Cleaner submerged in the pool.
- Control Box connected and plugged into a GFCI outlet.
- Wi-Fi and wireless-enabled smart device.
- Wi-Fi router with sufficient signal strength at the Control Box.
- IMPORTANT: Have your Wi-Fi network password available.





### 3.2 Connect your Cleaner to iAquaLink

- Open iAquaLink app on your mobile device, then Sign Up or Log In.
- Complete all required fields in the Account Setup page and agree to the Terms and Conditions.
- On the My Systems page, click + in the upper right-hand corner to add a system.
- Choose “Robotic Cleaner”. Follow in app instructions to add your cleaner and connect it to your home router.
- On the Control Box, press 
  - Blue BLINKING LED: searching for signal or wireless device
  - Blue SOLID LED: paired with phone or connected to internet

**NOTE:** Errors during connection may be the results of insufficient Wi-Fi signal strength at the control box location. If you are unable to improve signal strength, you may need a Wi-Fi extender to boost your signal strength.

**NOTE:** An incorrect password may also be that cause of a connection error. If the signal strength at the control box is good, double check the network name and credentials for the router you are trying to access.

### 3.3 iAquaLink Control Home Screen

	Start/Stop Cleaning
	Remote
	Clean Mode
	Lift System

### 3.4 Start / Stop Cleaning and Adjust Cleaning Time from App

The factory default cleaning mode is set to Floor, Wall, Waterline.

- From the Home screen, select Cleaning Mode to view and select.
- From the Home screen, press the Start/Stop button to begin cleaning.
- The app displays the cycle time in hours and minutes. Press +/- to increase or decrease cleaning time in 15-minute increments.
- Press Start/Stop button to interrupt and cancel an in-progress cleaning cycle.

### 3.5 Using Remote Control in App

Use your mobile device as a remote control.

**IMPORTANT:** Only use remote control when in view of the cleaner.

- From the main screen, select REMOTE.
- Drive the cleaner using the directional controls.

**NOTE:** If you experience significant delays between the app command and cleaner response, you may have a weak Wi-Fi signal or other connectivity challenges that interfere with the immediacy of the remote control functions.

### 3.6 Initiating Lift System from the App

Use Lift System to easily retrieve the robot from the pool. Lift System can be activated at any time during or after a cleaning cycle.

- From the Home screen, select Lift System  to enter automated procedure.
- Use the Left and Right controls to rotate the cleaner to face the wall of your choice.
- Press the Start Button to drive the cleaner up the wall it is facing. The cleaner will wait at the water line to be retrieved.

**NOTE:** To stop the procedure at any time, press and release the button again.

- Remove the cleaner from the pool using the handle. The cleaner will quickly expel water to allow for lighter, easier removal.

**NOTE:** Never lift the cleaner of the pool by the floating cable.

### 3.7 In-App Error Message and Troubleshooting

If an error occurs, cleaning will be interrupted, and the app will display an error message. The message will display:

- The error code and name
- A brief description of the error
- A set of troubleshooting steps you can take to resolve the error (if available for the error type)

Tap “Clear Error” when you believe you have fixed the problem and want to try again or anytime you want to return to the home screen.

### 3.8 System Settings

Access System Settings by pressing the gear icon in the upper right-hand corner of the app screen.

## Section 4. Storage Guidelines

Store the cleaner in a protected and dry area out of reach of children, pets, etc.

- Disconnect cleaner from the power source.
- Disconnect the floating cable from the control box.
- Starting at the cleaner head, untangle all kinks and coils in the floating cable. Lay the cable in the sun to loosen any tangling memory.
- Loosely coil the cable into a loop for storage near the cleaner.
- Store at least 11.5 ft (3.5 m) away from the pool edge.
- Keep out of direct sunlight.
- Avoid rain and inclement weather.
- Do not leave the cleaner in the water after prolonged periods when not in use.

## Section 5. Maintenance

### **⚠ WARNING**

Disconnect the product from the power supply to avoid injury.

### 5.1 Cleaning the Cleaner

- Rinse with clean (non-chlorinated) water and mild soap avoiding harsh solvents.
- Do not let the product dry in the sun.

### 5.2 Cord Tangling

Tangling can occur more frequently when the cleaner is not attended to after each cleaning cycle. Proper installation, general maintenance and the following troubleshooting steps can help to avoid cable challenges.

## IMPORTANT

Cleaner power cable may become tangled if correct procedure is not followed after each cleaning cycle.

**NOTE:** Place all of the floating cable in the water to allow free movement in your pool from the central point. Spread out the floating cable ensuring there are no kinks or coils in the cable.

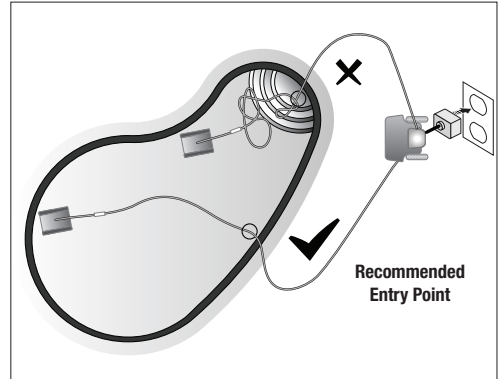

If tangling occurs, follow these steps:

- Remove the cleaner from the pool. When the cleaner is within arm's reach, use the handle to remove from the water. Never lift the cleaner out of the pool by the floating cable (see **1**).
- Hold the cleaner vertically to drain.
- Unplug power to the cleaner at the control box (see **2**).
- Untangle all kinks and coils in the floating cable starting at the cleaner head. Lay the cable in the sun to loosen any tangling memory. (see **3**).

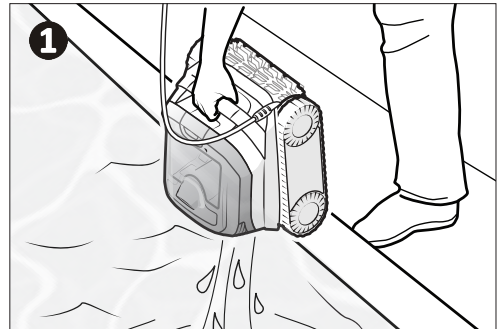

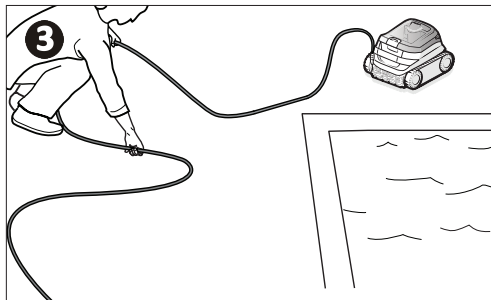
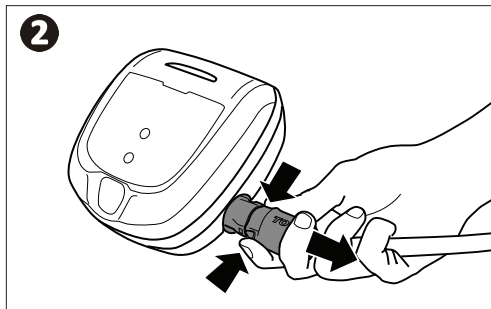

### 5.3 Cleaning the Filter Canister

- The filter canister should be rinsed with clean (non-chlorinated) water at the end of each cycle.
- Periodically, clean the canister with soapy water and a soft bristle brush to remove fine particles that clog the material. Rinse with clean (non-chlorinated) water.

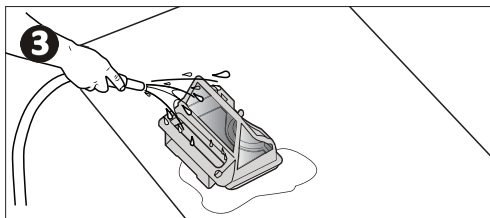
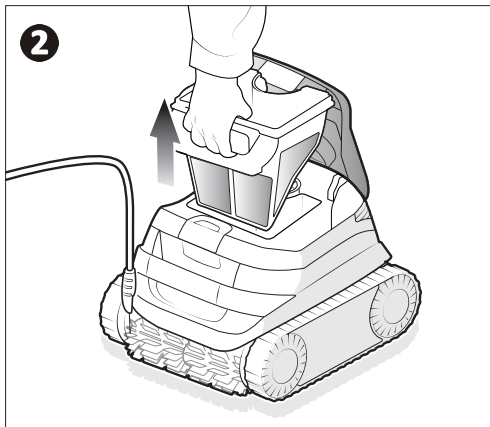
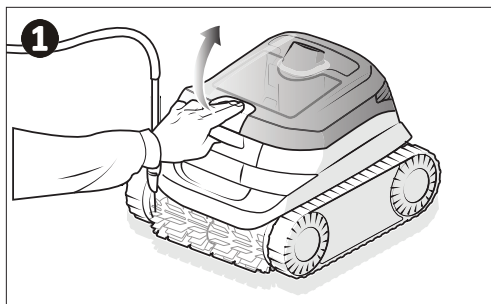

### 5.4 Cleaning the Impeller Area

#### **⚠ WARNING**

Disconnect the product from the power supply and wear gloves to avoid injury.

- Unscrew the flow guide (see **1**).
- Lift to remove the flow guide (see **2**).
- Wear protective gloves when touching the impeller.
- Firmly grip and pull off the impeller (see **3**).
- Carefully remove debris that may be wrapped around and blocking the impeller.

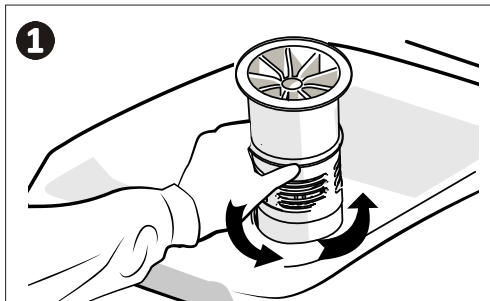

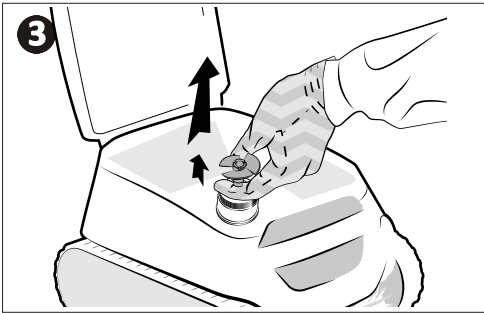
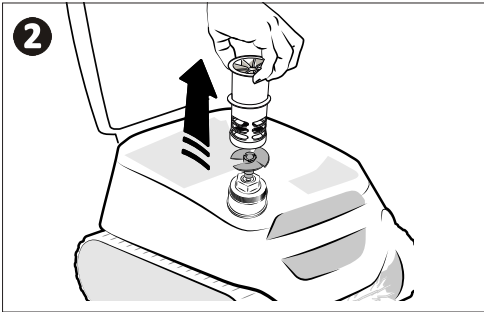

- Remove the brushes by pulling apart the tabs as shown:

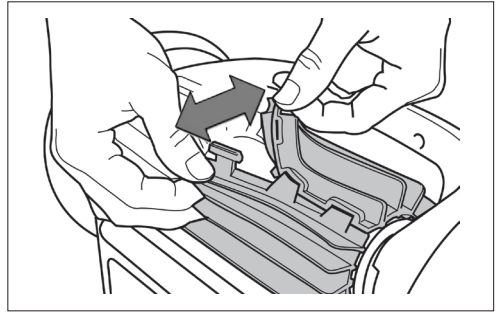

- To replace, position a new brush without tabs under the brush holder (see **1**).
- Roll the brush around the support, slide the tabs into the slits and pull until the wide edge passes through each slit (see **2**).
- Cut the tabs with scissors to be level with the other blades (see **3**).

### 5.5 Replacing the Brushes

- Replace the brushes if wear indicators are as shown:

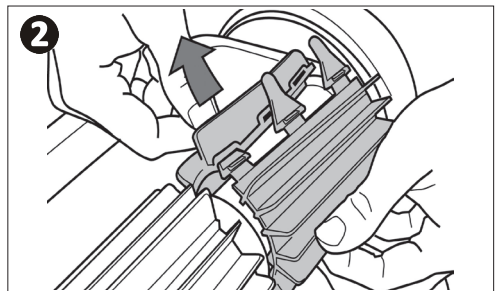
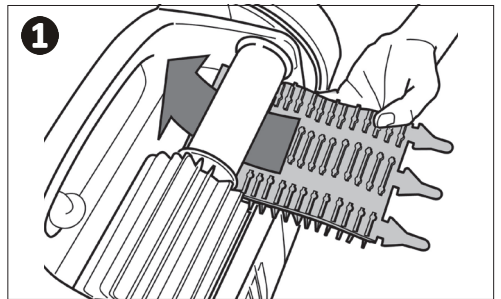
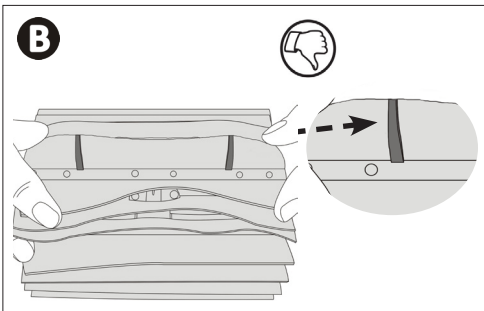
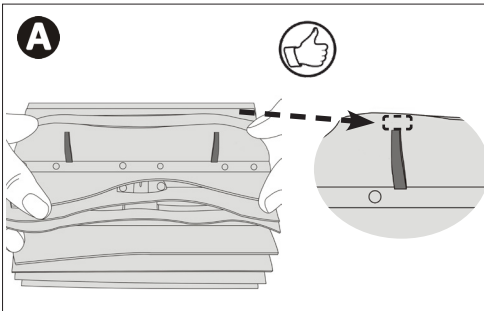

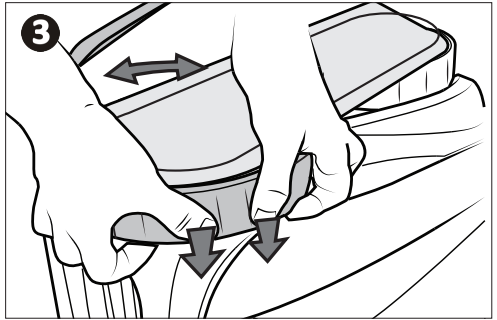
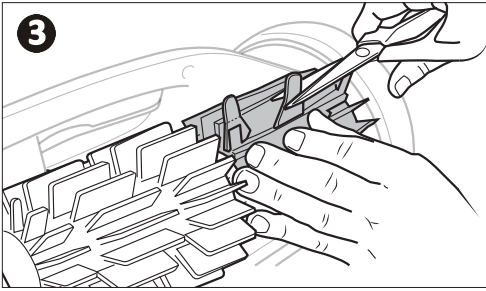

### 5.6 Replacing Tracks



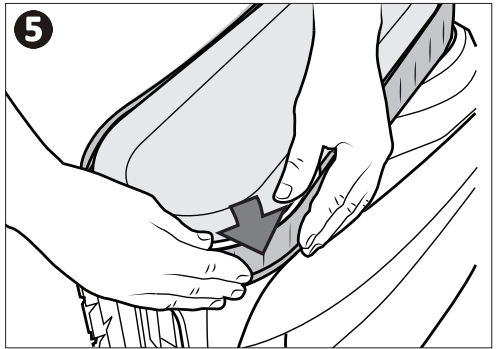
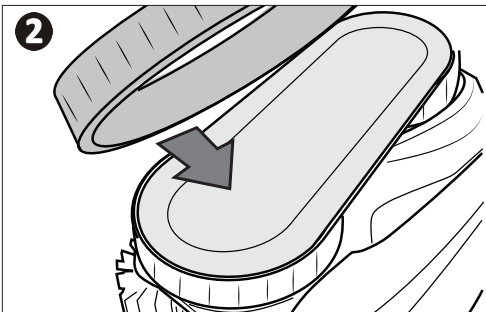
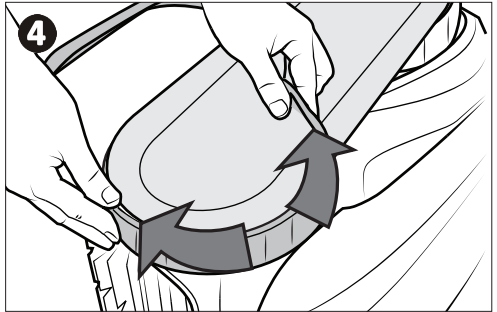
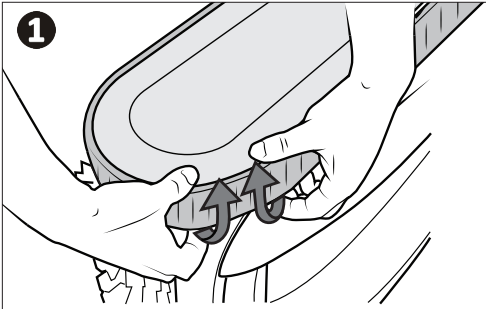

- Replace the tracks if the wear indicator is worn, the treads are smooth, or the tracks are loose.
- Pull the old track over the wheel to remove (see **1**).
- Replace the track by positioning the rib toward the body of the cleaner (see **2**).
- Align one side of the track onto the wheel and fit the rib into the wheel groove (see **3**).
- Push and position the rib of the inner side of the track in the groove of the wheel. If needed, turn the wheel gently to help guide the track into the groove (see **4**).
- Continue to work the track into the groove on the other wheel until the entire track is seated securely (see **5**).

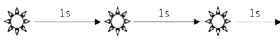

## Section 6. Troubleshooting

- If the status indicator on the control box flashes to alert the user. Follow the recommended troubleshooting tips below.
- User alerts can also be accessed in the iAquaLink® app (on connected models only).

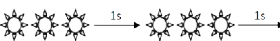
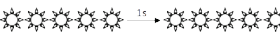
### 6.1 Error Codes

Flashing LED	Error	Solutions
 <p><b>1 flash / 1 second pause</b></p>	Communication	<ul style="list-style-type: none"> <li>• Disconnect and reconnect the cleaner.</li> <li>• Check that the cable is properly connected to the control box.</li> <li>• Check that nothing is interfering with the cable connection area.</li> <li>• If this does not resolve the problem, contact your local retailer for a diagnostic review or contact Technical Support at 1-800-822-7933.</li> </ul>
 <p><b>2 flash / 1 second pause</b></p>	Right traction motor Left traction motor Right traction motor consumption Left traction motor consumption	<ul style="list-style-type: none"> <li>• Check that debris or the cable is not preventing the brushes or the tracks from rotating freely.</li> <li>• Check that nothing is interfering with the cable connection area.</li> <li>• Rotate the track by a quarter of a turn in the same direction until it rotates smoothly</li> <li>• If this does not resolve the problem, contact your local retailer for a diagnostic review or contact Technical Support at 1-800-822-7933.</li> </ul>
 <p><b>3 flash / 1 second pause</b></p>	Cleaner out of the water	<ul style="list-style-type: none"> <li>• Turn the cleaner off.</li> <li>• Clean the filter thoroughly.</li> <li>• Put it back in the water, shaking to release the air bubbles.</li> <li>• Restart the cycle.</li> <li>• If this does not resolve the problem, contact your local retailer for a diagnostic review or contact Technical Support at 1-800-822-7933.</li> </ul>
	Pump motor Pump motor consumption	<ul style="list-style-type: none"> <li>• Check that no debris or hair is blocking the impeller.</li> <li>• Clean the filter thoroughly.</li> <li>• If this does not resolve the problem, contact your local retailer for a diagnostic review or contact Technical Support at 1-800-822-7933.</li> </ul>
<b>iAquaLink Control Models Only</b>		
 <p><b>5 flash / 1 second pause</b></p>	Software update failed or incomplete	<ul style="list-style-type: none"> <li>• Disconnect and reconnect the control box to restart the update.</li> <li>• If this does not resolve the problem, contact your local retailer for a diagnostic review or contact Technical Support at 1-800-822-7933.</li> </ul>
 <p><b>Rapid flashing</b></p>	Update in progress	<ul style="list-style-type: none"> <li>• Wait for the update to complete.</li> <li>• Do not disconnect the power cable from the cleaner during an update.</li> </ul>
N/A	Connection error	<ul style="list-style-type: none"> <li>• Check the status of the iAquaLink control connected LEDs on the control box.</li> </ul>
N/A	A red dot appears in the "My systems" list	<ul style="list-style-type: none"> <li>• Robot not plugged in or not connected to the home Wi-Fi network. If the dot is red when the control box is plugged in and if the iAquaLink control connected LEDs are lit up, refresh the screen (by swiping downwards).</li> <li>• If the dot turns green: the robot is ready for use.</li> </ul>

#### Deleting an error code:

**Using the control box:** After following the troubleshooting solutions, press any key to delete the error code (except the  button).

**From the iAquaLink app** (connected models only): After following the troubleshooting solutions, press **Clear Error**.

## 6.2 General Troubleshooting

The following list provides some helpful hints for troubleshooting common challenges when using the cleaner.

User Issue	Possible Cause	Suggested Solution
The cleaner does not stay on the pool surface or is floating excessively	There is air trapped inside the cleaner housing	<ul style="list-style-type: none"> <li>Remove cleaner from pool and re-submerge.</li> </ul>
	The filter canister is full or dirty	<ul style="list-style-type: none"> <li>Dispose of debris and thoroughly clean the filter canister with mild soap and a soft brush. Then, re-submerge the cleaner.</li> </ul>
The cleaner is not climbing walls	The filter canister is full or dirty	<ul style="list-style-type: none"> <li>Dispose of debris and thoroughly clean the filter canister with mild soap and a soft brush. Then, re-submerge the cleaner.</li> </ul>
	Confirm appropriate pool chemistry	<ul style="list-style-type: none"> <li>Speak with your pool service professional. Do not leave cleaner in the pool during any chemical treatments.</li> </ul>
The cleaner is not moving	Not connected to electricity	<ul style="list-style-type: none"> <li>The outlet the control box is connected to, is not supplying electrical power. Check that the outlet to which the control box is connected is receiving electricity.</li> </ul>
	Cycle not started	<ul style="list-style-type: none"> <li>Press the Start button to initiate a cleaning cycle.</li> </ul>
	Reset needed	<ul style="list-style-type: none"> <li>Disconnect the unit power and reconnect after 20 seconds. If the problem is not resolved, contact your local retailer to request a diagnostic review or contact Technical Support at 1-800-822-7933.</li> </ul>
Cable is tangling in the pool	Cable is not spread evenly in the water	<ul style="list-style-type: none"> <li>Verify the floating cable enters the water near the middle of the pool length. Spread all of the floating cable carefully in the pool, ensuring there are no kinks or coils. Ensure the cable is not too tightly wrapped or coiled when storing. If the problem persists, lay the cable straight in the sun to relax it and remove kinks.</li> </ul>
The cleaner is not cleaning the pool effectively	Filter canister is full or dirty	<ul style="list-style-type: none"> <li>Dispose of debris and thoroughly clean the filter canister with mild soap and a soft brush. Then, re-submerge the cleaner.</li> </ul>
	Brushes are worn	<ul style="list-style-type: none"> <li>Check the wear indicator(s). Contact your local dealer for spare parts.</li> </ul>
	Cable is excessively tangled	<ul style="list-style-type: none"> <li>Untangle the twisted cord and lay in sun to reduce memory.</li> </ul>

### 6.3 iAquaLink Troubleshooting (not available on all models)

This information can help to troubleshoot connection and setup challenges between the iAquaLink app and the cleaner.

#### How to Connect:

You must connect to the home router (network) by first establishing a direct connection between the control box and your smart device.

## IMPORTANT

It is recommended to locate the control box as close to the home router as practical. Do not use an extension cord.

#### Common iAquaLink Troubleshooting

Remember, if you get a new Wi-Fi router, reset the defaults of your current Wi-Fi router or simply change your Wi-Fi network password, you will have to re-establish the connection between your cleaner and the router.

User Issue	Possible Cause	Suggested Solution
All lights are off	Bright sunlight	Shield the lights to block sunlight and re-check if the lights are lit.
	Control box is unplugged	Plug the control box into a GFCI outlet.
	Power outage	Verify that the breaker is on and electricity is being supplied to the outlet.
	Lost internet connection	Check internet connection - network may be down.
Wi-Fi is off	Router is off	Turn router on.
	Router password was changed	Reset router with new password.
Wi-Fi light is flashing	Lost internet connection	Check internet connection - Network may be down.
	Control box is too far from home router	Relocate the control box as near to the home router as practical. Do not use an extension cord.
	Weak Wi-Fi signal	<ul style="list-style-type: none"> <li>• Check for adequate Wi-Fi signal strength.</li> <li>• With a Windows laptop, go to Network Connections in the Control Panel. Check Signal Strength meter under Wireless Network Connection icon while standing near the control box.</li> <li>• With a smart device, search for, download, and use an app that can check signal strength while standing near the control box. If Wi-Fi signal is weak, consider installing a Wi-Fi extender.</li> </ul>
	Connectivity issue with local Wi-Fi or connection to the server	Contact your local internet service provider. <ul style="list-style-type: none"> <li>• Unplug your control box and wait 10 seconds. Plug in the box again and see if lights illuminate.</li> <li>• Check Internet connection - Network may be down.</li> </ul>
Status light is continuously flashing	Antenna firmware update in progress	Wait for the update to complete and the flashing to end. Do not disconnect the power cable from the cleaner during an update.
Power LED is blinking fast	Firmware update in progress	Wait for blinking to stop, indicating update is complete. Do not unplug from power during an update.





**A Fluidra Brand** | [PolarisPool.com](https://PolarisPool.com) | [PolarisPool.ca](https://PolarisPool.ca)  
2882 Whiptail Loop # 100, Carlsbad, CA 92010, USA | 1.800.822.7933  
2-3365 Mainway, Burlington, ON L7M 1A6, Canada | 1.800.822.7933

©2025 Fluidra. All rights reserved. All trademarks are property of their respective owners. App Store is a service mark of Apple, Inc., registered in the U.S. and other countries. Google Play and the Google Play logo are trademarks of Google LLC.

H0895700\_REVC