

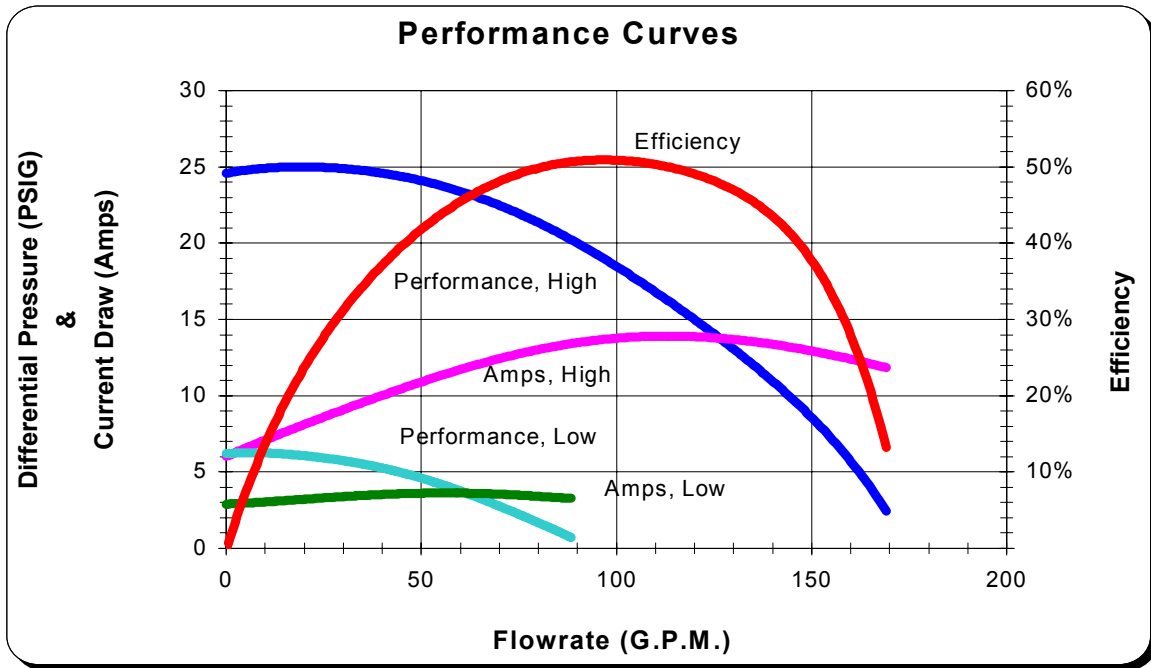

## Product Specification Sheet

### Model XP2551521

The XP2 pump for portable spas provides improved overall performance and enhanced energy efficiency. Uniquely designed for today's many-jetted spas requiring increased flow, the XP2 also offers whisper quiet performance through the design of the high volumetric volute.



These performance curves are a result of in-lab testing using 3" suction line, actual performance may vary based on manufacturing tolerances and application.

Performance Table						
PSI	2.4	5.9	15.1	21.4	24.7	24.6
GPM	169.1	160	120	80	40	0
<b>BEP</b>	<b>100 GPM</b>					

Motor Data					
<b>Manufacturer:</b>	Emerson	<b>AF Part Number:</b>	93525104	<b>Model:</b>	T55MWCMP-1197
<b>HP:</b>	1.5	<b>FLA:</b>	15.0/3.9	<b>Volts:</b>	115
<b>Freq:</b>	60	<b>Phase:</b>	1	<b>Frame:</b>	48
				<b>Speed:</b>	2

Shipping Weight: 31.91 lbs Pumps per pallet layer: 10

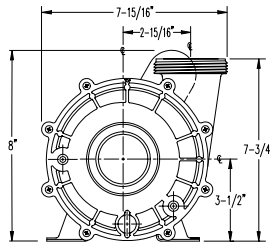
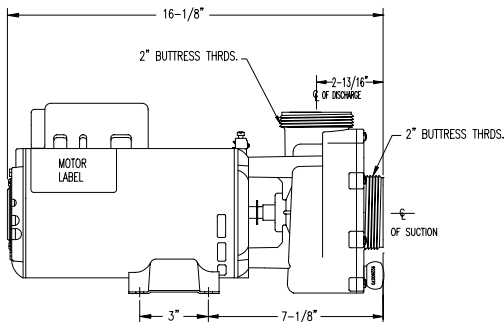

AQUA-FLO, LLC  
 PUMPS FOR THE LEISURE WATER INDUSTRY™  
 5651 Schaefer Ave., Chino, CA USA 91710 TEL: (909) 591-7453 FAX: (909) 627-5660 [www.aqua-flo.com](http://www.aqua-flo.com)  
 Shipping Address: 5002 Lindsay Court, Chino, CA USA 91710 TEL: (909) 993-5340